



# A1 Series PVC High Speed Door Application



**PE210 (750W)**



**PE510 (1500W)**



**PE715 (2200W)**



**PE915 (3800W)**

## Description

SERVO solution for PVC high speed door.  
Compact design and precise control, suitable for VERY intensive industrial application.

## Feature

Motor with integrated drive unit / Internal Absolute Encoder / Torque Auto-adjusting System / LCD (EN) Display / Modbus protocol.

## Size

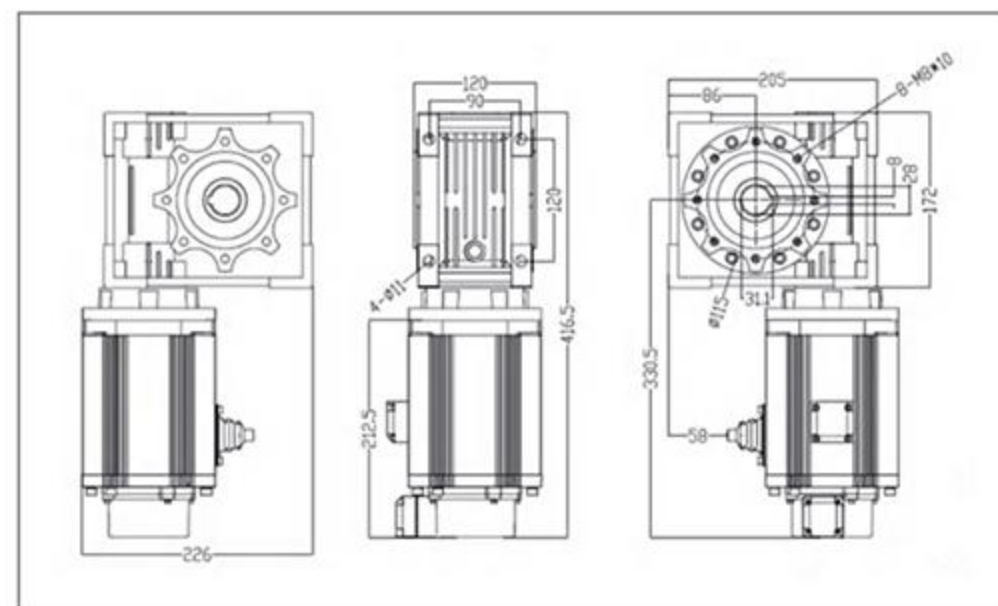

► **PE210 (750W) Motor**

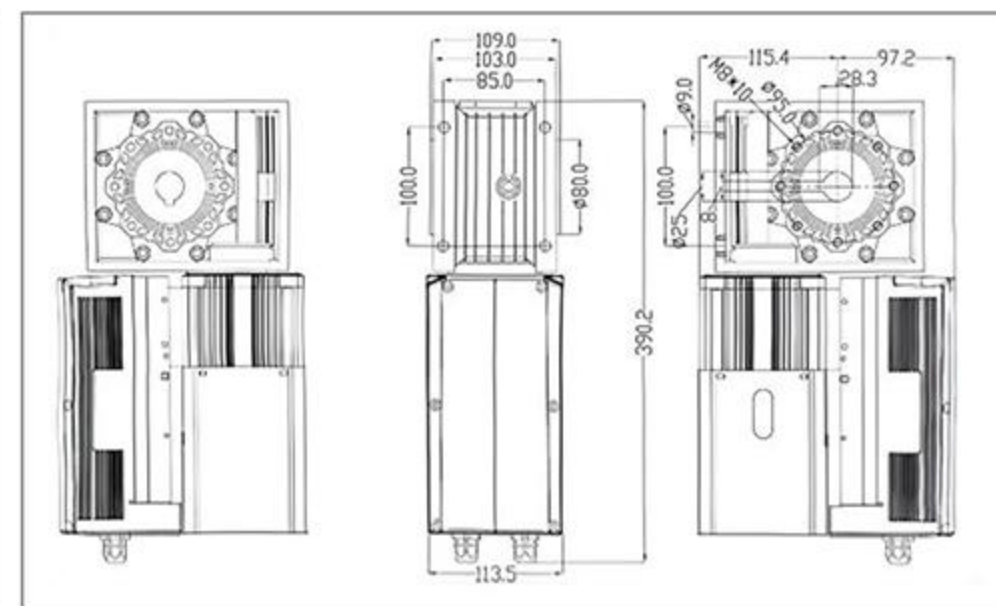

► **PE510 (1500W) Motor**

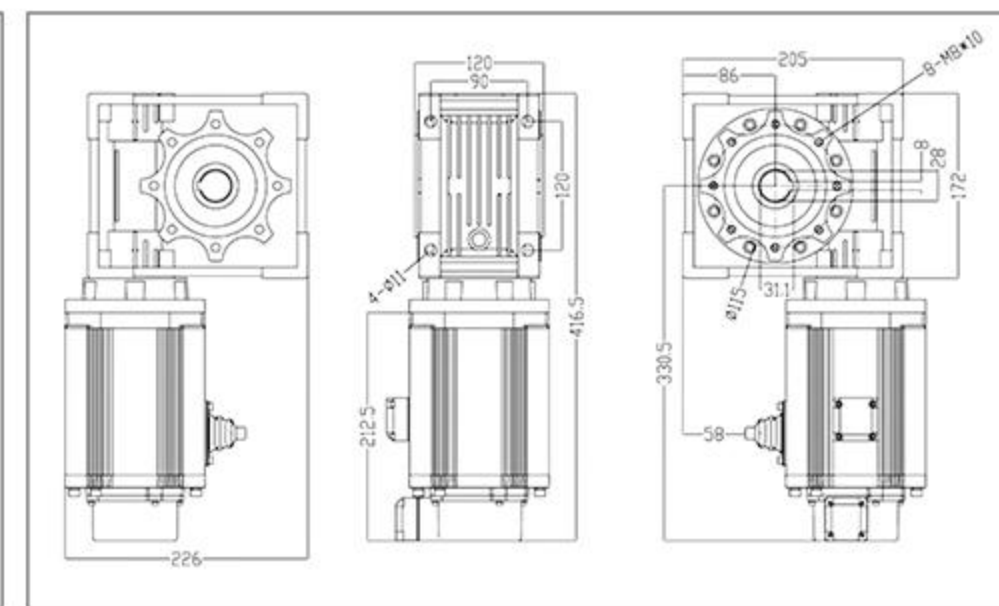

► **PE715 (2200W) Motor**

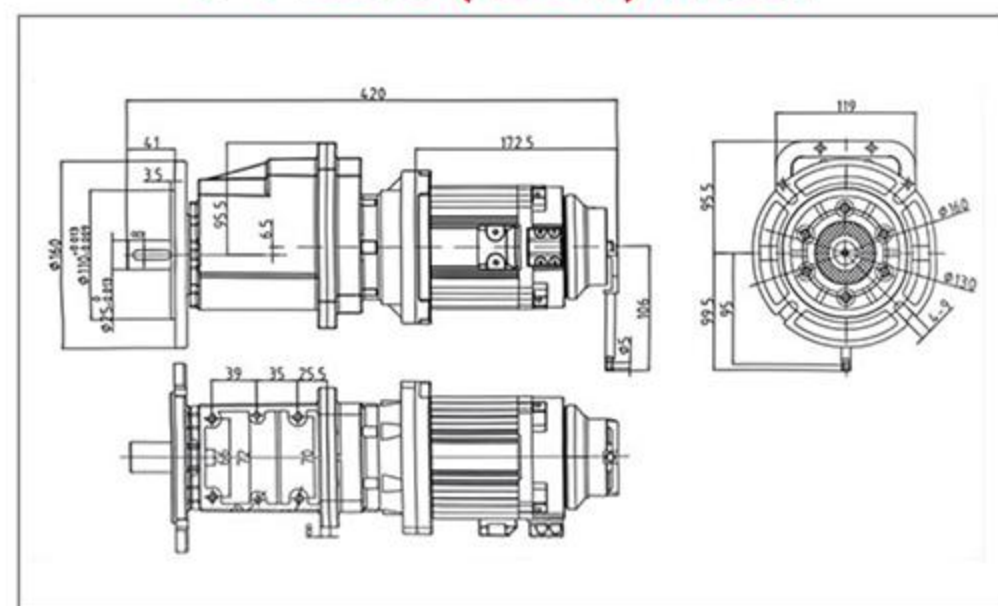

► **PE915 (3800W) Motor**

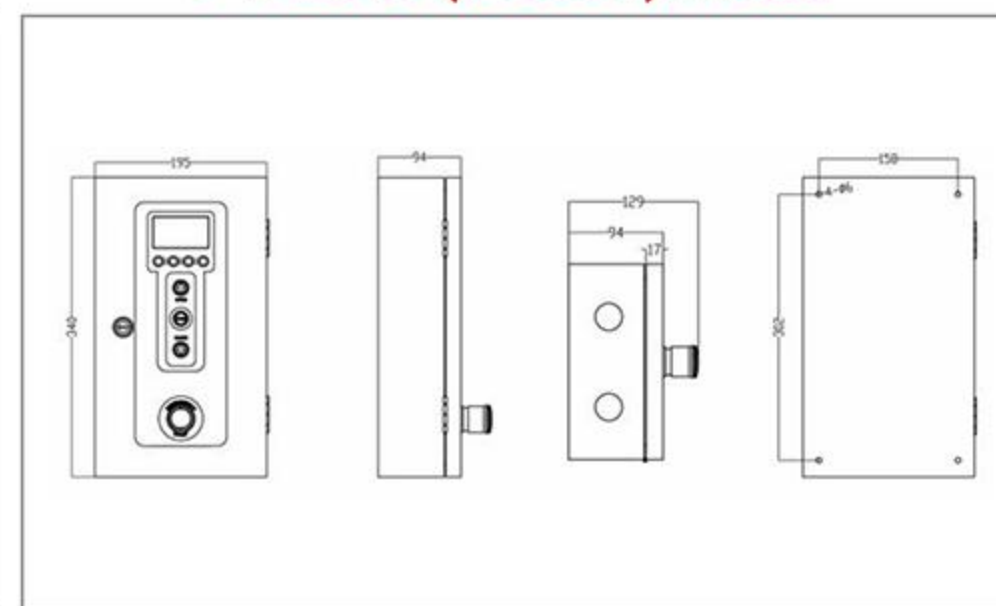

► **PE210 / PE510 Controller**

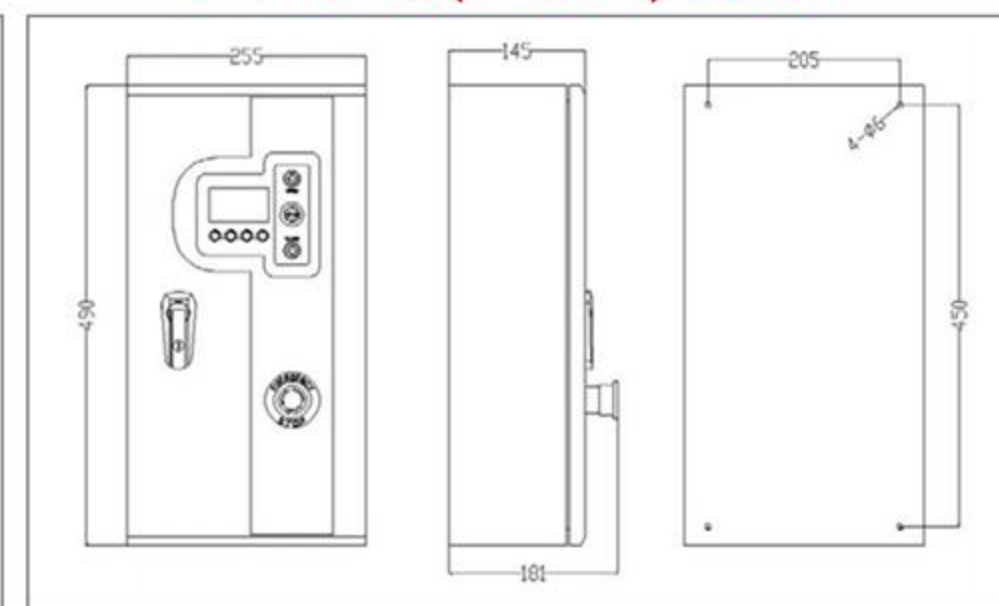

► **PE715 / PE915 Controller**

## Guide to choosing

Motor Type	Roller Diameter: 114mm		Roller Diameter: 140mm	
	Max. Load & Area	Door Max. Speed	Max. Load & Area	Door Max. Speed
PE210 / 750W (1:15)	38kg, 10m <sup>2</sup> ≤	1m/s	31kg, 8m <sup>2</sup> ≤	1.2m/s
PE210 / 750W (1:20)	50kg, 13m <sup>2</sup> ≤	0.7m/s	41kg, 10m <sup>2</sup> ≤	0.9m/s
PE510 / 1500W (1:15)	76kg, 20m <sup>2</sup> ≤	1m/s	61kg, 16m <sup>2</sup> ≤	1.2m/s
PE510 / 1500W (1:20)	100kg, 25m <sup>2</sup> ≤	0.7m/s	82kg, 20m <sup>2</sup> ≤	0.9m/s
PE715 / 2200W (1:15)	/	/	113kg, 28m <sup>2</sup> ≤	0.36m/s
PE715 / 2200W (1:25)	/	/	188kg, 47m <sup>2</sup> ≤	/
PE915 / 3800W (1:25)	/	/	780kg, 140m <sup>2</sup> ≤	/
PE915 / 3800W (1:40)	/	/	870kg, 160m <sup>2</sup> ≤	/

Other reduction rate is also available as request.

## Specifications

Model	PE210	PE510	PE715	PE915
<b>Technic Data</b>				
Power Input	750W	1500W	2200W	3800W
Power Supply	220V ± 10%, 50 / 60Hz	220V ± 10%, 50 / 60Hz	220V ± 10%, 50 / 60Hz	220V ± 10%, 50 / 60Hz
Reducer	Worm Gear (RV50 1:15 / 20)	Worm Gear (RV63 1:15 / 20)	Worm Gear (RV63 1:15 / 25)	Worm Gear (RV90 1:25 / 40)
Shaft Diameter	25MM	25MM	28MM	35MM
Rated Motor Speed	2500rpm	2500rpm	2000rpm	1500rpm
Output Speed	167rpm (1:15) / 125rpm (1:20)	167rpm (1:15) / 125rpm (1:20)	133rpm (1:15) / 80rpm (1:25)	60rpm (1:25) / 37.5rpm (1:40)
Rated Motor Torque	2.39NM	5.72NM	10.5NM	24NM
Output Torque	35NM (1:15) / 47NM (1:20)	85NM (1:15) / 114NM (1:20)	157NM (1:15) / 262NM (1:25)	600NM (1:25) / 960NM (1:40)
Protection Rating (Motor)	IP54	IP54	IP65	IP65
Emergency Release	Hand Crank	Hand Crank	N / A	N / A
Operating Temperature	-10~+40°C (MAX.-20~+50)	-10~+40°C (MAX.-20~+50)	-10~+40°C (MAX.-20~+50)	-10~+40°C (MAX.-20~+50)
Limit Switch	Absolute Internal Encoder	Absolute Internal Encoder	Absolute Internal Encoder	Absolute Internal Encoder
Self Lock	Electronic Mechanical Brake	Electronic Mechanical Brake	Electronic Mechanical Brake	Electronic Mechanical Brake
Max Cycles per Hour	60 cycles / hour	60 cycles / hour	30 cycles / hour	20 cycles / hour
Standard Cable Length	4m	5m	8m	15m
Soft run	●	●	●	●
Certificate	CE	CE	CE	CE

## Functions

	PE210	PE510	PE715	PE915
Control Panel Display	LCD (EN)	LCD (EN)	LCD (EN)	LCD (EN)
Mode	Auto / Manu / Jog	Auto / Manu / Jog	Auto / Manu / Jog	Auto / Manu / Jog
Open / Close speed	Adjustable	Adjustable	Adjustable	Adjustable
Automatic Re-closing	1-240s (0 = disabled)	1-240s (0 = disabled)	1-240s (0 = disabled)	1-240s (0 = disabled)
Partial Opening Height	Adjustable	Adjustable	Adjustable	Adjustable
Status Display	Torque / Speed / Height	Torque / Speed / Height	Torque / Speed / Height	Torque / Speed / Height
Status Display	●	●	●	●
Open Slowdown	●	●	●	●
Distance Set	●	●	●	●
Close Slowdown	●	●	●	●
Distance Set	●	●	●	●
Error / History error	●	●	●	●
Maintenance Reminding	●	●	●	●
Open Delay	●	●	●	●
Self-Diagnosis	●	●	●	●
Statistics Management	●	●	●	●
Contact (NC / NO)	●	●	●	●

## Inputs / Outputs

- Start | Open | Close | Stop | Reverse
- Partial Open
- Safety 2
- Interlock
- Programmable Relay X2
- Panel Signal
- Built-in Remote Control

## Recommended Accessories



Interface for extended Programmable Relay X2



RS485 To Ethernet Converter

# A2 Series PVC High Speed Door Application



PE200 (750W)



PE500 (1500W)

## Description

SERVO solution for PVC high speed door.

Compact design and precise control, suitable for VERY intensive industrial application.

## Feature

Motor with integrated drive unit / Internal Absolute Encoder / Torque Auto-adjusting System / LCD (EN) Display / Modbus protocol.

## Size

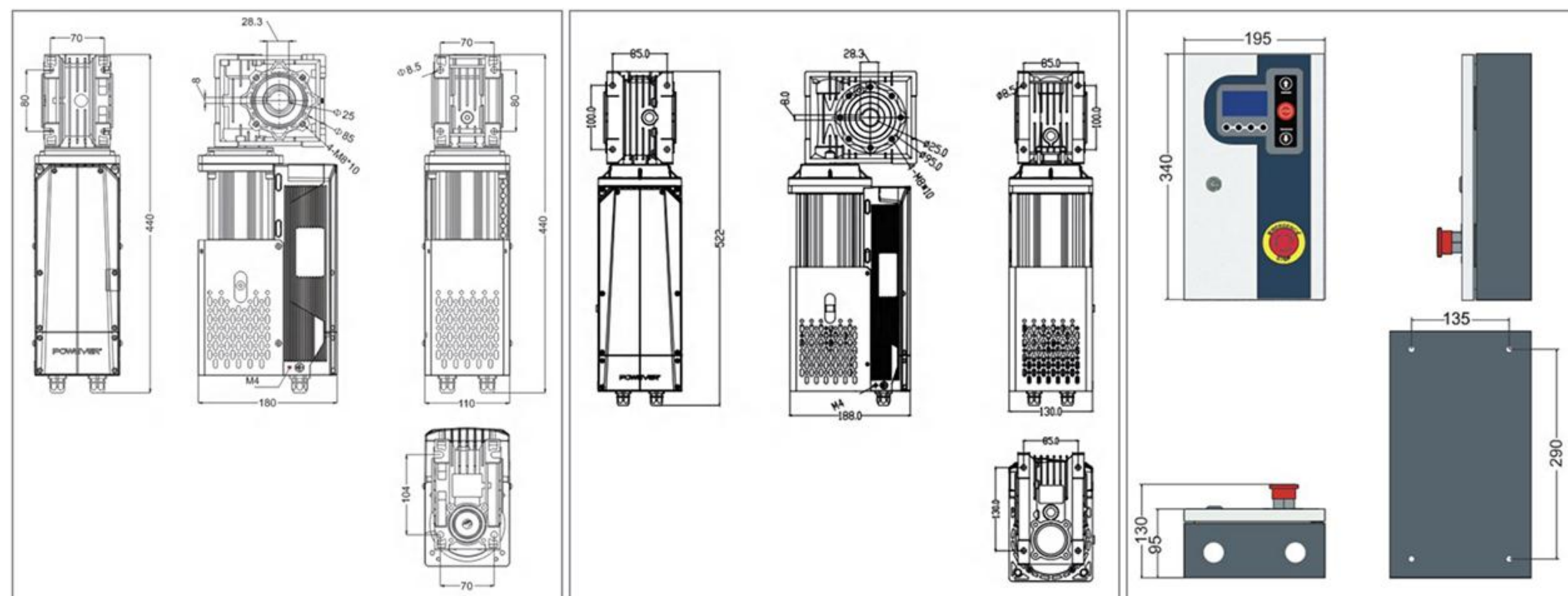

▶ PE200 (750W) Motor

▶ PE500 (1500W) Motor

▶ PE200 / 500 Controller

## Guide to choosing

Motor Type	Roller Diameter: 114mm		Roller Diameter: 140mm	
	Max. Load & Area	Door Max. Speed	Max. Load & Area	Door Max. Speed
PE200 / 750W (1:15)	38kg, 10m <sup>2</sup> ≤	1m/s	31kg, 8m <sup>2</sup> ≤	1.2m/s
PE200 / 750W (1:20)	50kg, 13m <sup>2</sup> ≤	0.74m/s	41kg, 10m <sup>2</sup> ≤	1.2m/s
PE500 / 1500W (1:10)	80kg	1.2m/s	70kg, 21m <sup>2</sup> ≤	1.5m/s
PE500 / 1500W (1:15)	120kg	0.8m/s	90kg, 24m <sup>2</sup> ≤	1m/s

Other reduction rate is also available as request.

## Specifications

Model	PE200	PE500
<b>Technic Data</b>		
Power Input	750W	1500W
Power Supply	220V ± 10%, 50 / 60Hz	220V ± 10%, 50 / 60Hz
Reducer	Worm Gear (RV50 1:15 / 1:20)	Worm Gear (RV50 1:15 / 1:20)
Shaft Diameter	25MM	25MM
Rated motor speed	2500rpm	2000rpm
Output speed	167rpm (1:15) / 125rpm (1:20)	200rpm (1:10) / 133rpm(1:15)
Rated motor Torque	2.86NM	7.2NM
Output Torque	42NM (1:15) / 57NM (1:20)	72NM (1:10) / 108NM(1:15)
Protection Rating (Motor)	IP54	IP54
Emergency release	Hand Crank	Hand Crank
Operating Temperature	-10~+40°C (MAX.-20~+50)	-10~+40°C (MAX.-20~+50)
Limit Switch	Absolute Internal Encoder	Absolute Internal Encoder
Self Lock	Electronic Mechanical Brake	Electronic Mechanical Brake
Max Cycles per Hour	60 cycles / hour	60 cycles / hour
Standard Cable Length	4m	5m
Soft run	●	●
Certificate	CE	CE
<b>Functions</b>		
Control Panel Display	LCD (EN)	LCD (EN)
Mode	Auto / Manu / Jog	Auto / Manu / Jog
Open / Close speed	Adjustable	Adjustable
Automatic Re-closing Time	1-240s (0 = disabled)	1-240s (0 = disabled)
Partial Opening Height	Adjustable	Adjustable
Status Display	Torque / Speed / Height	Torque / Speed / Height
Open Slowdown Distance Set	●	●
Close Slowdown Distance Set	●	●
Error / History error	●	●
Maintenance Reminding	●	●
Open Delay	●	●
Self-Diagnosis	●	●
Statistics Management	●	●
Contact (NC / NO) Adjustable	●	●

## Inputs / Outputs

Start | Open | Close | Stop | Reverse  
 Partial Open  
 Emergency open  
 Emergency Stop  
 Safety 1 | Safety 2  
 Interlock  
 Open Limit Switch  
 Close Limit Switch  
 Programmable Relay X2

## Recommended Accessories



Interface for extended Programmable Relay X2



RS485 To Ethernet Converter

# A4 Series PVC High Speed Door Application



**PE200B (750W)**



**PE500B (1500W)**



**PE700B (2200W)**

## Description

Servo solution for PVC high speed door.  
Compact design and precise control, suitable for VERY intensive industrial application.

## Feature

Double encoders. Internal encoder controls the travel, speed and torque (close loop). External encoder double checks the limit switch. Torque Auto-adjusting System. Torque automatically changes according to the load and set speed. EN/CN control panel convenient for operation and provides on-time status, historical faults and data. Modbus protocol.

## Size

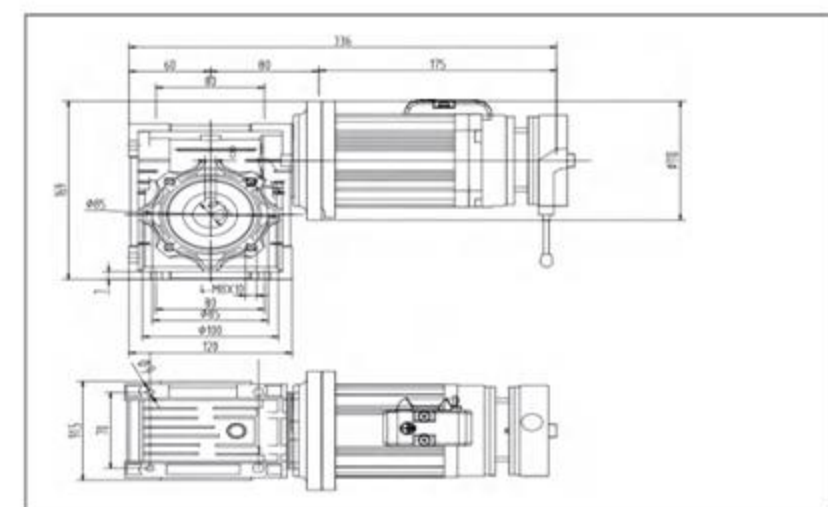

► PE200B Motor

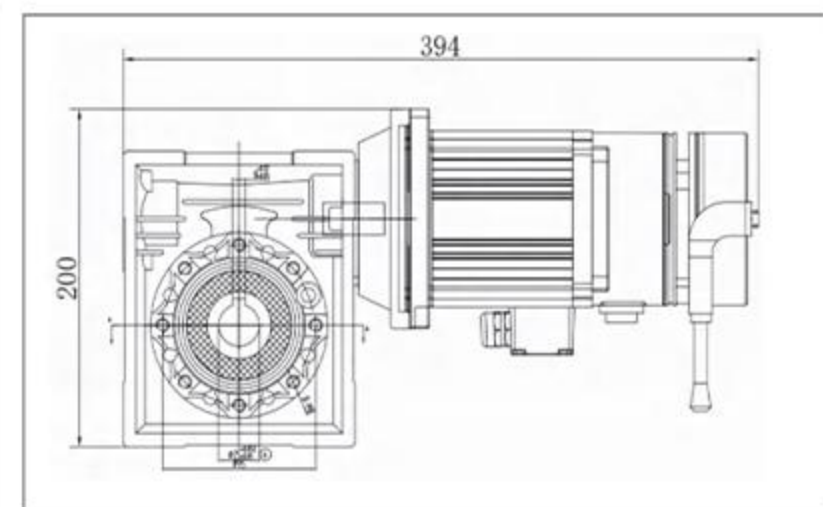

► PE500B Motor

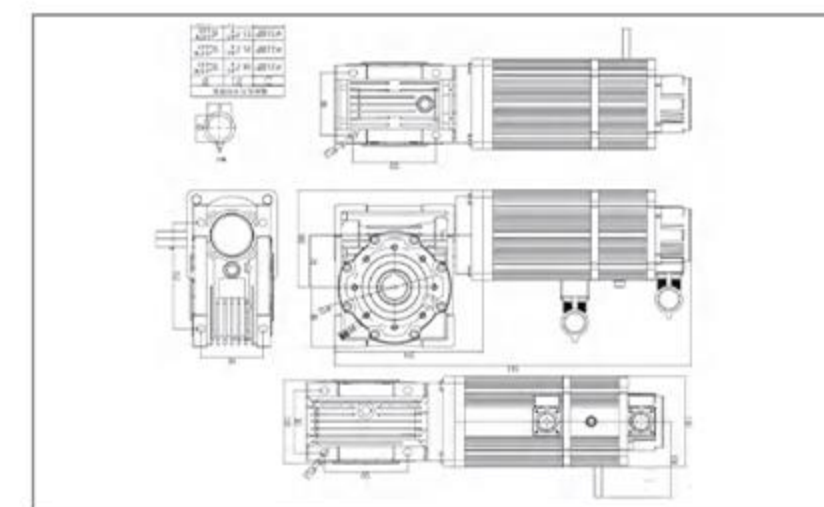

► PE700B Motor

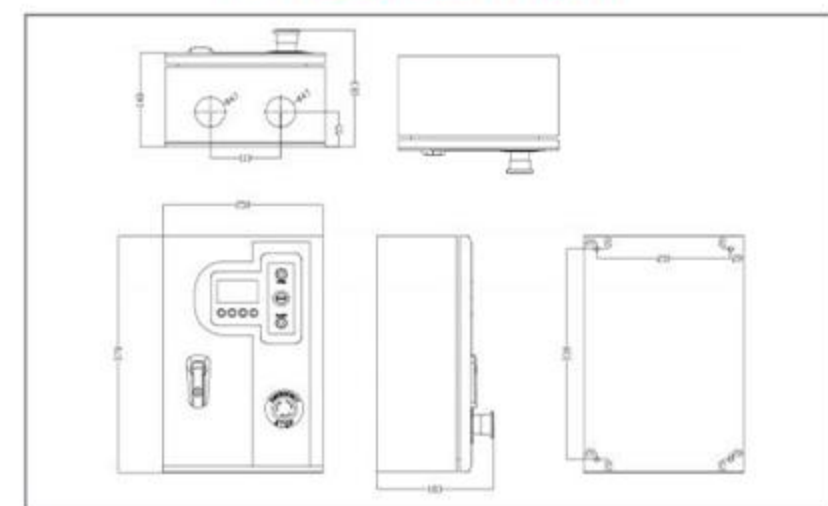

► PE200B Motor

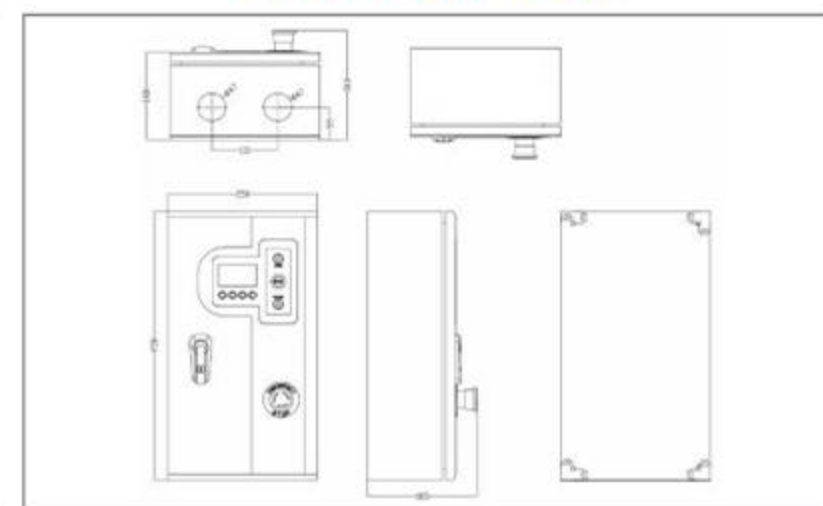

► PE500B Motor

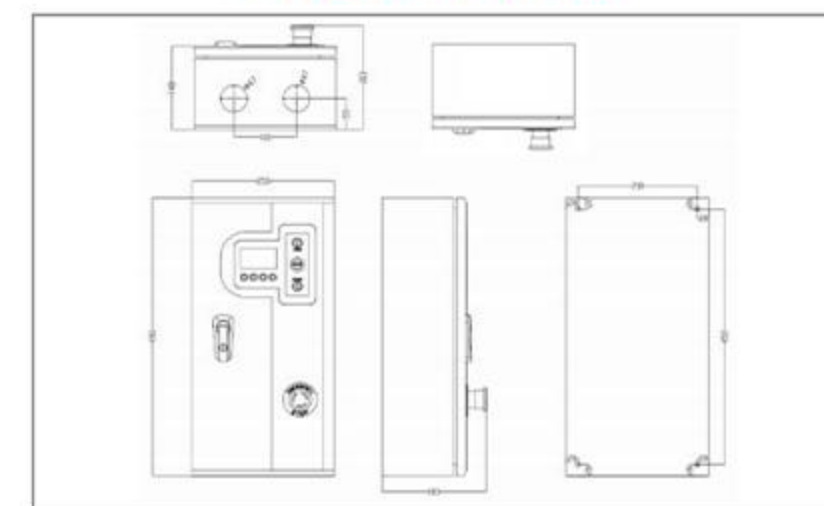

► PE700B Motor

## Guide to choosing

Motor Type	Roller Diameter: 114mm		Roller Diameter: 140mm	
	Max. Load & Area	Door Max. Speed	Max. Load & Area	Door Max. Speed
PE200B / 750W (1:10)	40kg, 10m <sup>2</sup> ≤	1.2m/s	30kg, 9m <sup>2</sup> ≤	1.5m/s
PE200B / 750W (1:15)	60kg, 14m <sup>2</sup> ≤	0.8m/s	45kg, 12m <sup>2</sup> ≤	1m/s
PE 500B (1500W) (1:10)	80kg≤, 21m <sup>2</sup> ≤	1.2m/s	70kg, 18m <sup>2</sup> ≤	1.5m/s
PE 500B (1500W) (1:15)	120kg≤, 24m <sup>2</sup> ≤	0.8m/s	90kg, 24m <sup>2</sup> ≤	1m/s
PE700B (2200W) (1:15)	240KG≤, 45m <sup>2</sup> ≤	0.6m/s	180kg, 45m <sup>2</sup> ≤	0.7m/s
PE700B (2200W) (1:25)	320KG≤, 60m <sup>2</sup> ≤	0.35m/s	280kg, 55m <sup>2</sup> ≤	0.4m/s

Other reduction rate is also available as request.

## Specifications

Model	PE200B	PE500B	PE700B
<b>Technic Data</b>			
Power Input	750W	1500W	2200W
Power Supply	220V ± 10%, 50/60 Hz	220V ± 10%, 50/60 Hz	220V ± 10%, 50/60 Hz
Reducer	Worm Gear (RV50 1:10 / 1:15)	Worm Gear (RV50 1:10 / 1:15)	Worm Gear (RV50 1:15 / 1:25)
Shaft Diameter	25MM	25MM	28MM
Rated motor speed	2000RPM	2000RPM	1500RPM
Output speed	200rpm (1:10) / 133rpm (1:15)	200rpm (1:10) / 133rpm (1:15)	100rpm (1:15) / 60rpm (1:25)
Rated motor Torque	3.6NM	7.2NM	15NM
Output Torque	36NM (1:10) / 54NM (1:15)	72NM (1:10) / 108NM (1:15)	225NM (1:10) / 375NM (1:15)
Protection Rating (Motor)	IP42	IP54	IP65
Emergency release	Hand Crank	Hand Crank	N/A
Operating Temperature	-10~+40°C (MAX.-20~+50)	-10~+40°C (MAX.-20~+50)	-10~+40°C (MAX.-20~+50)
Limit Switch	External Encoder Internal Encoder	External Encoder Internal Encoder	Absolute Internal Encoder
Self Lock	Electronic Mechanical Brake	Electronic Mechanical Brake	Electronic Mechanical Brake
Max Cycles per Hour	60 cycles / hour	60 cycles / hour	60 cycles / hour
Standard Cable Length	4m	5m	8m
Soft run	●	●	●
Certificate	CE	CE	CE
<b>Functions</b>			
Control Panel Display	LCD (EN)	LCD (EN)	LCD (EN)
Mode	Electronic Limit	Electronic Limit	Electronic Limit
Open / Close speed	Adjustable	Adjustable	Adjustable
Automatic Re-closing Time	1-240s (0 = disabled)	1-240s (0 = disabled)	1-240s (0 = disabled)
Partial Opening Height	Adjustable	Adjustable	Adjustable
Status Display	Current / Speed / Height	Current / Speed / Height	Current / Speed / Height
Slow start and stop	●	●	●
Close Slowdown Distance Set	●	●	●
Error / History error	●	●	●
Maintenance Reminding	●	●	●
Open Delay	●	●	●
Self-Diagnosis	●	●	●
Statistics Management	●	●	●
Contact (NC / NO) Adjustable	●	●	●

## Inputs / Outputs

- Start | Open | Close | Stop | Reverse
- Partial Open
- Emergency open
- Emergency Stop
- Safety 1 | Safety 2
- Interlock
- Open Limit Switch
- Close Limit Switch
- Programmable Relay X2 (PE200)
- Programmable Relay X4 (PE500 / PE700)

## Recommended Accessories



RS485 To Ethernet Converter

## Main Functions

- ※ Full range of oil-immersed gearboxes, featuring high torque, low noise, stable operation, and long service life design (Low-temperature oil is optional for cold regions)
- ※ Manual chain mechanism with automatic clutch, simple and convenient to use
- ※ Door opening and closing speeds adjustable within a certain range
- ※ Equipped with soft start and slow stop functions for smoother door opening and closing
- ※ Software thermal protection function to reduce accidental damage
- ※ Safety protection class reaches IP54
- ※ Mechatronics integration, with optional configurations such as remote controls, safety airbags, and photoelectric switches
- ※ Electronic limit optional, enabling convenient and accurate stroke adjustment
- ※ Universal manual zipper, allowing machine installation without direction restrictions
- ※ Certified to European CE standards and compliant with national industry standards.

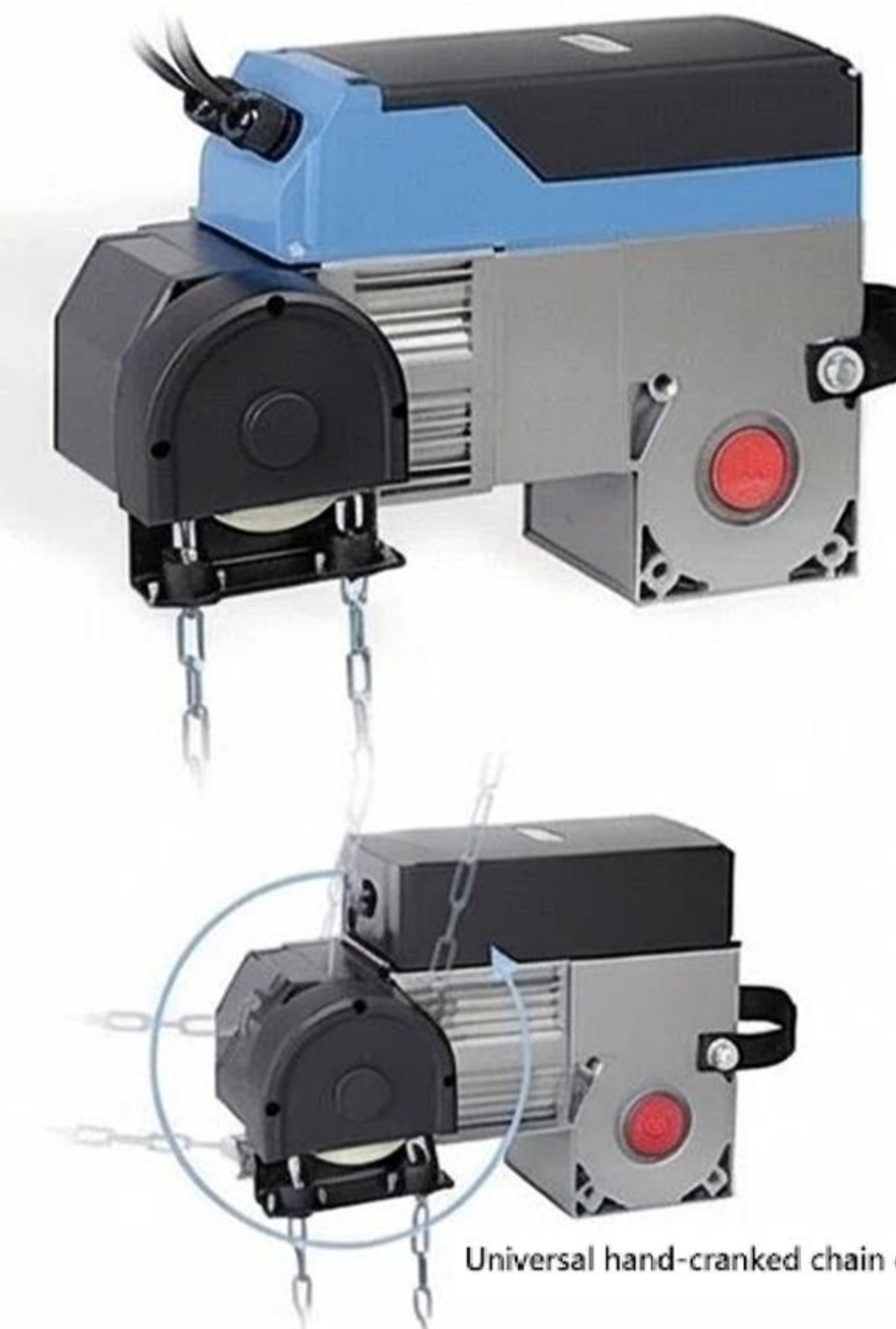

Universal hand-cranked chain drive

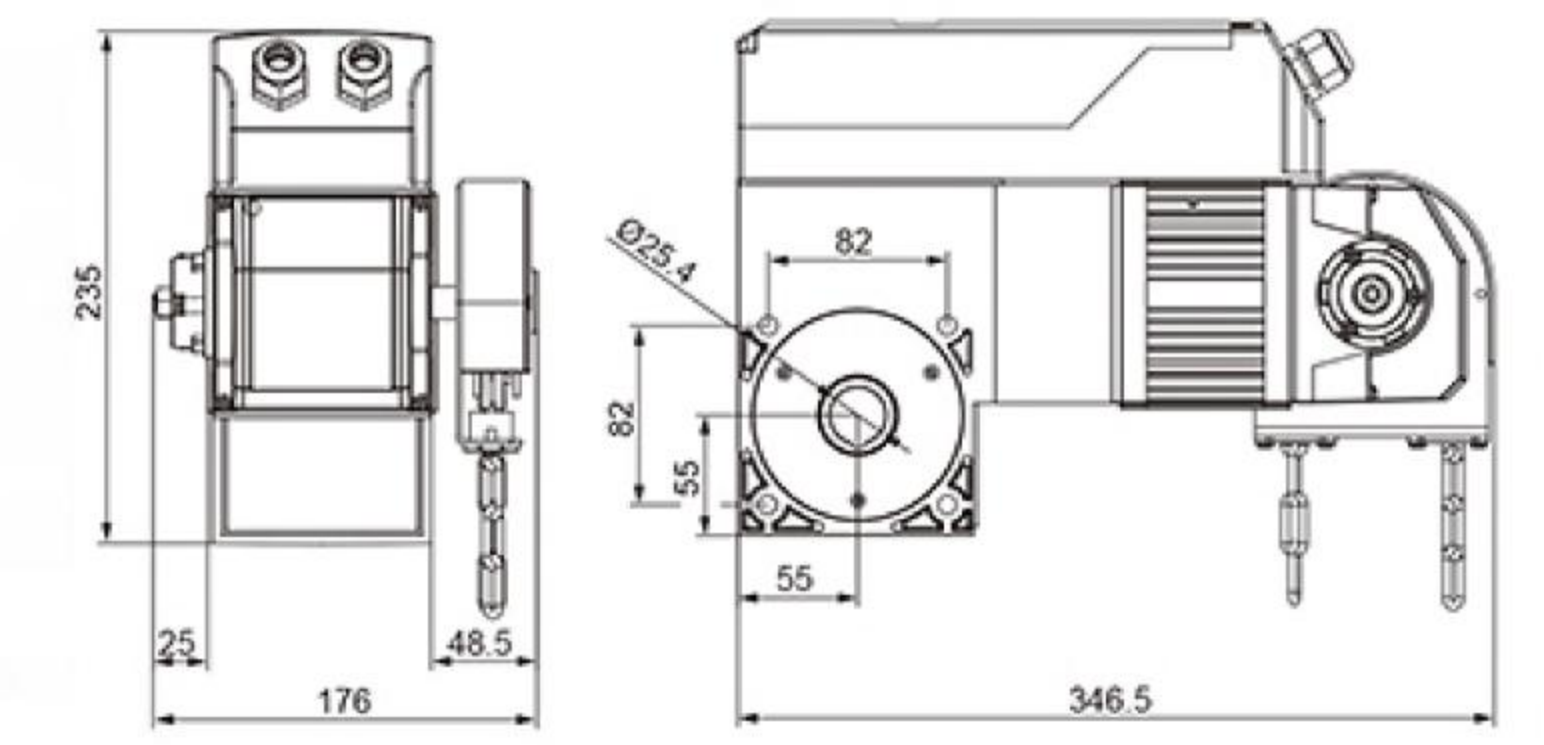

Universal hand-cranked chain drive

## Technical Parameters

Model	KG90SF	KG100SF	KG110SF	KG160SF
Power Supply	220V/50Hz	220V/50Hz	220V/50Hz	220V/50Hz
Output Torque	90N.m	100N.m	110N.m	160N.m
Output Speed	40rpm	18rpm	40rpm	16rpm
Motor rotate speed	2500rpm	3000rpm	2500rpm	1500rpm
Motor Power	750W	750W	1300W	1500W
Continuous Working time	10min	10min	10min	10min
Ambient temperature	-20°C~+50°C (-40°C Customizable)	-20°C~+50°C (-40°C Customizable)	-20°C~+50°C (-40°C Customizable)	-20°C~+50°C (-40°C Customizable)
Output Shaft Aperture	φ25.4mm	φ25.4mm	φ25.4mm	φ25.4mm
Flat Key Dimensions	6×5×70mm	6×5×70mm	6×5×70mm	6×5×70mm
Net Weight	12kg	14kg	12.5kg	14kg
Dimensions	100×233×311mm	100×233×362mm	100×233×311mm	100×233×350mm
Max. Travel Distance	20/32cycles	20/32cycles	20/32cycles	20/32cycles
Max. Door Size	<30m <sup>2</sup>	<40m <sup>2</sup>	<40m <sup>2</sup>	<50m <sup>2</sup>
Limit mode	Electronic limit switch	Electronic limit switch	Electronic limit switch	Electronic limit switch
Hand zipper direction	Universal hand chain	Universal hand chain	Universal hand chain	Universal hand chain
speed adjustable range	20-50r/min	15-25r/min	20-50r/min	14-26r/min

### ☑ Standard Configuration    ☐ Optional Configuration



Mounting Bracket    Control Box    Tiangou Wireless Controller    Infrared Protection Switch    Wired Airbag    Warning Light    Remote Controller

## Main Function

- ※ Products with a highly integrated all-in-one design based on the latest modular concept. Both small and medium-sized industrial door operators can be customized into all-in-one machines.
- ※ The button box is quickly connected to the main unit via a network cable, enabling wire-free connection. This simplifies installation and effectively prevents wiring errors.
- ※ It features a screen display function.
- ※ The full-function button box allows for limit setting and remote control learning. It can also be connected to external devices such as safety airbags, photoelectric switches, and warning lights.
- ※ An optional built-in Tian Gou wireless control module is available.
- ※ It adopts an absolute encoder and electronic limit, allowing for convenient and accurate stroke adjustment.
- ※ The maximum output torque can reach 200N·m, suitable for door bodies with a maximum area of 50m<sup>2</sup>.

## Small-Sized Industrial Door Operator



### Main Function

- ✘ Full range of oil-immersed gearboxes, featuring high torque, low noise, stable operation, and long service life design (low-temperature oil is optional for cold regions);
- ✘ Manual chain mechanism with automatic clutch, simple and easy to use;
- ✘ Motor thermal protection function to reduce accidental damage;
- ✘ Safety protection class up to IP54;
- ✘ Mechatronics integration, with optional devices such as remote controls, safety airbags, and photoelectric switches;
- ✘ Electronic limit for convenient and accurate stroke adjustment;
- ✘ Universal manual zipper, allowing machine installation without direction restrictions;
- ✘ The equipped button box is compact and exquisite, making it easier to select the installation position; high-voltage electricity is converted to low-voltage in the button box (with high-voltage located at the machine end), ensuring safer use;
- ✘ Certified to European CE standards and compliant with national industry standards.



Universal hand-cranked chain drive

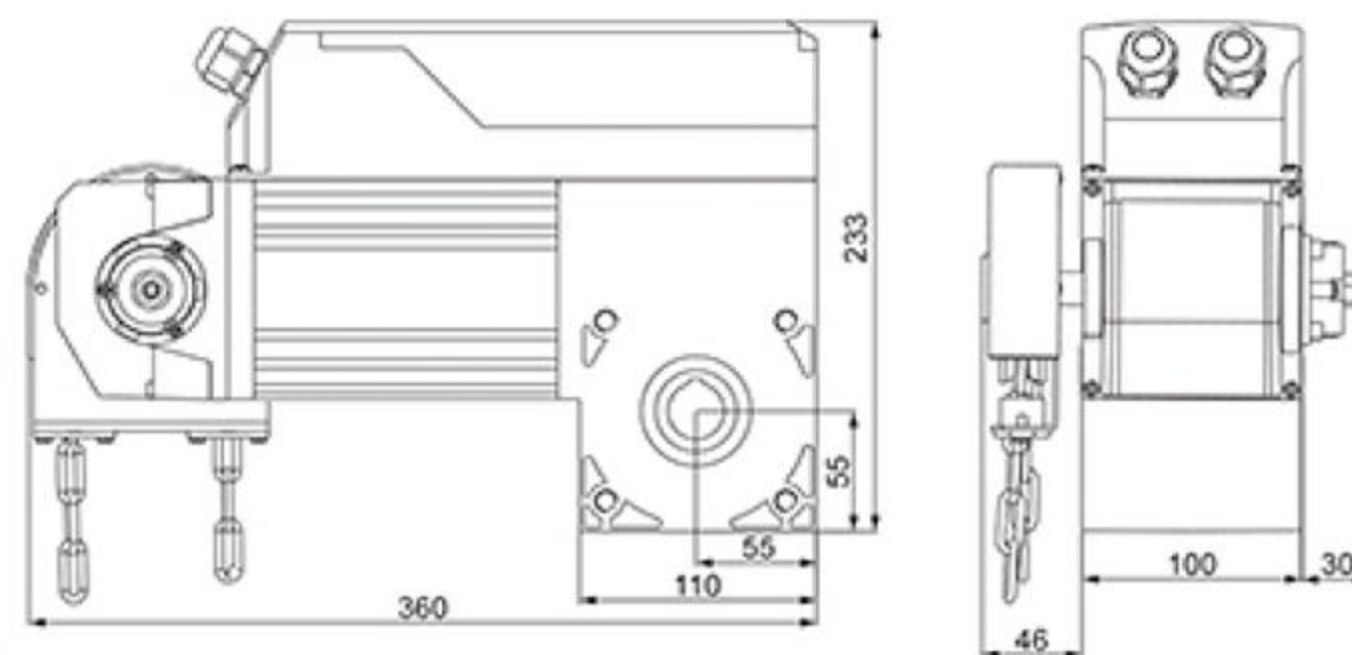

### Technical Parameters

Model	KG50	KG50S	KG70	KG70S
Power Supply	220V/50Hz	380V/50Hz	220V/50Hz	380V/50Hz
Output Torque	50N.m	50N.m	70N.m	70N.m
Output Speed	32rpm	32rpm	24rpm	24rpm
Motor rotate speed	1400rpm	1400rpm	1400rpm	1400rpm
Motor Power	300W	400W	550W	400W
Continuous Working time	10min	20min	10min	20min
Ambient temperature	-20°C~+50°C (-40°C Customizable)	-20°C~+50°C (-40°C Customizable)	-20°C~+50°C (-40°C Customizable)	-20°C~+50°C (-40°C Customizable)
Output Shaft Aperture	φ25.4mm(φ31.8mm Customizable)	φ25.4mm(φ31.8mm Customizable)	φ25.4mm(φ31.8mm Customizable)	φ25.4mm(φ31.8mm Customizable)
Flat Key Dimensions	6×5×70mm	6×5×70mm	6×5×70mm	6×5×70mm
Net Weight	12kg	12kg	15kg	12kg
Dimensions	100×233×360mm	100×233×360mm	100×233×435mm	100×233×350mm
Max. Travel Distance	28cycles	28cycles	28/35cycles	28cycles
Max. Door Size	<18m <sup>2</sup>	<25m <sup>2</sup>	<30m <sup>2</sup>	<30m <sup>2</sup>
Limit mode	Electronic limit switch	Electronic limit switch	Electronic limit switch	Electronic limit switch
Hand zipper direction	Universal hand chain	Universal hand chain	Universal hand chain	Universal hand chain

Standard Configuration  Optional Configuration



## Medium-Sized Industrial Door Operator



### Main Function

- ✘ Full range of oil-immersed gearboxes, featuring high torque, low noise, stable operation, and long service life design (Low-temperature oil is optional for cold regions);
- ✘ Built-in limit lead screw for better waterproof performance;
- ✘ Built-in worm gear failure protection device for enhanced safety during use;
- ✘ Safety protection class reaches IP54;
- ✘ Motor thermal protection function to reduce accidental damage;
- ✘ Compatible with various protective devices such as infrared sensors, ground loop detectors, and safety airbags;
- ✘ Reserved small door interface to realize interlock function;
- ✘ Manual zipper can be used to open the door in case of power failure or maintenance;
- ✘ Equipped with functions including automatic door closing, motor delayed protection, and opening priority;
- ✘ The supplied button box is compact and exquisite, making it easier to select the installation position. High-voltage electricity is located at the machine end, while the button box uses low-voltage electricity for safer operation.

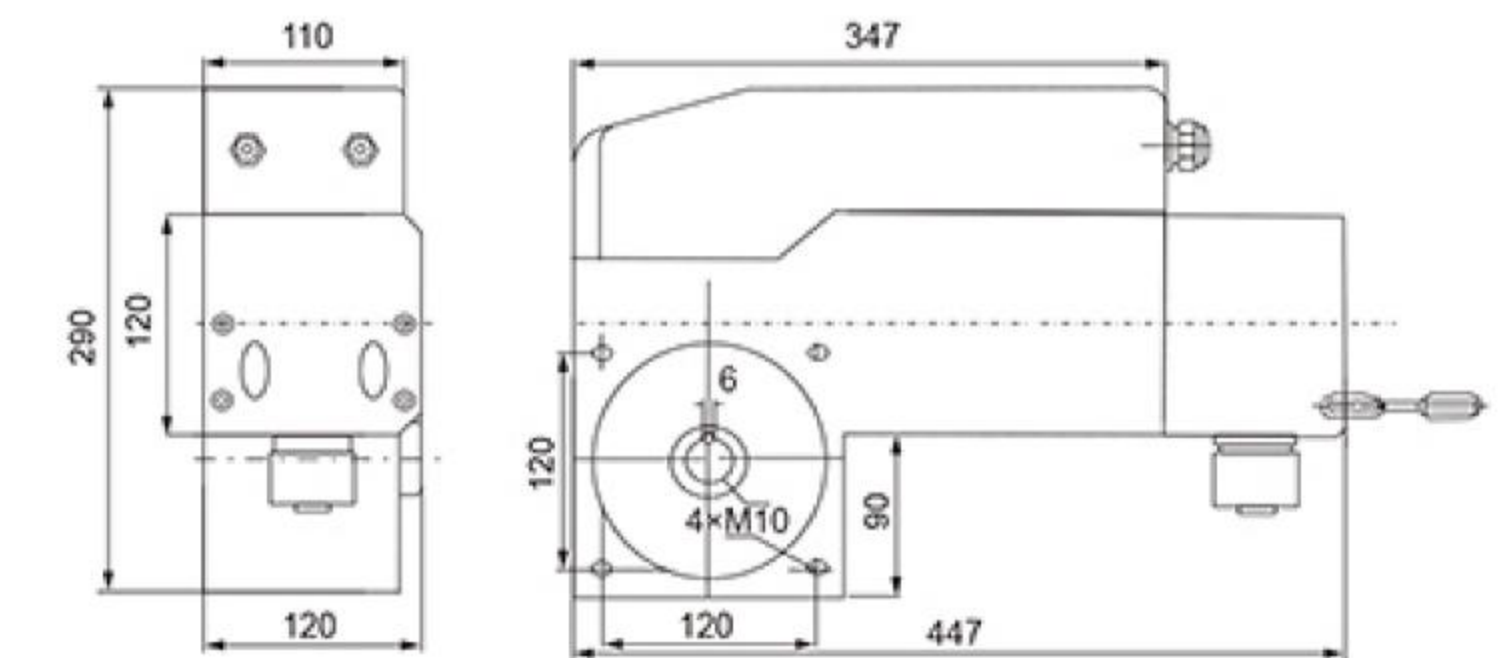

### Technical Parameters

Model	KG40	KG75S	KG100S	KG150S
Power Supply	220V/50Hz	380V/50Hz	380V/50Hz	380V/50Hz
Output Torque	40N.m	75N.m	100N.m	150N.m
Output Speed	24rpm	24rpm	24rpm	24rpm
Motor rotate speed	1400rpm	1400rpm	1400rpm	1400rpm
Motor Power	300W	400W	600W	700W
Continuous Working time	10min	20min	10min	15min
Ambient temperature	-20°C~+50°C (-40°C Customizable)	-20°C~+50°C (-40°C Customizable)	-20°C~+50°C (-40°C Customizable)	-20°C~+50°C (-40°C Customizable)
Output Shaft Aperture	φ25.4mm	φ25.4mm(φ31.8mm Customizable)	φ25.4mm(φ31.8mm Customizable)	φ25.4mm(φ31.8mm Customizable)
Flat Key Dimensions	6×5×70mm	6×5×70mm	6×5×70mm	6×5×70mm
Net Weight	12kg	12kg	14kg	15kg
Dimensions	100×233×350mm	100×233×360mm	100×233×420mm	100×243×435mm
Max. Travel Distance	28cycles	28cycles	28cycles	28/35cycles
Max. Door Size	<20m <sup>2</sup>	<30m <sup>2</sup>	<35m <sup>2</sup>	<45m <sup>2</sup>
Limit mode	Electronic limit switch	Electronic limit switch	Electronic limit switch	Electronic limit switch
Hand zipper direction	Universal hand chain	Universal hand chain	Universal hand chain	Universal hand chain

Standard Configuration  Optional Configuration

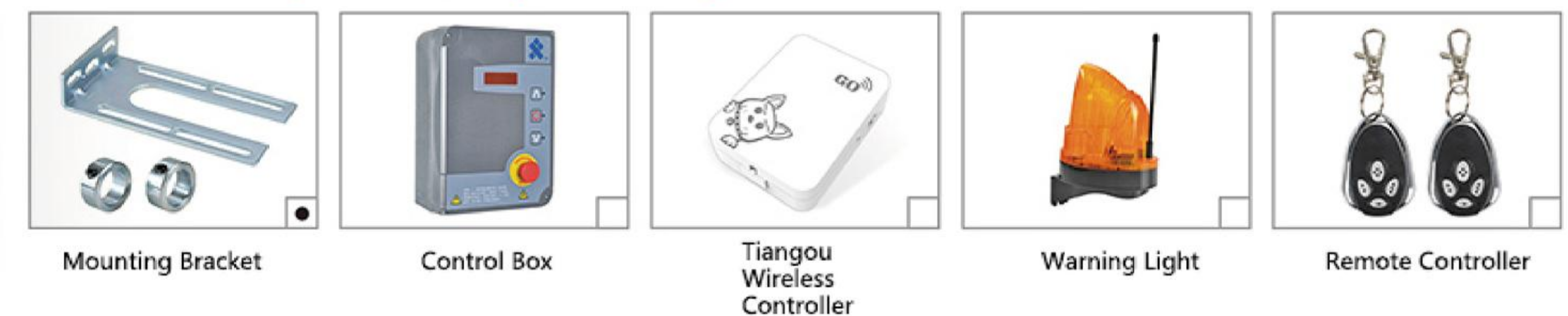

# Industrial Door Servo System

C25 Model/60N.M/0.65KW Industrial Door Servo System



## Control Box

Configuration Model: Industrial Door C60 Model  
Configuration Power: 60N.M  
Display Screen: LCD Screen (Chinese & English)



## Motor Assembly

Configuration Model: Industrial Door C60 Model  
Operating Power Supply: AC220V ±10%  
Standard Wire Length: 6M

### Dimensional Line Drawing of Industrial Door Control Box

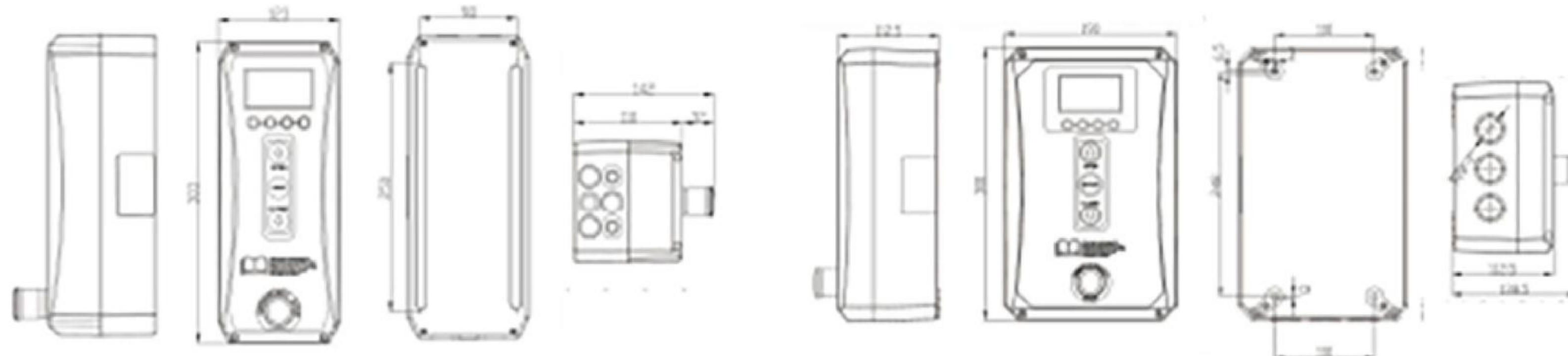

C-Series Small Control Box

C-Series Large Control Box

### Dimensional Line Drawing of Industrial Door Motor Unit

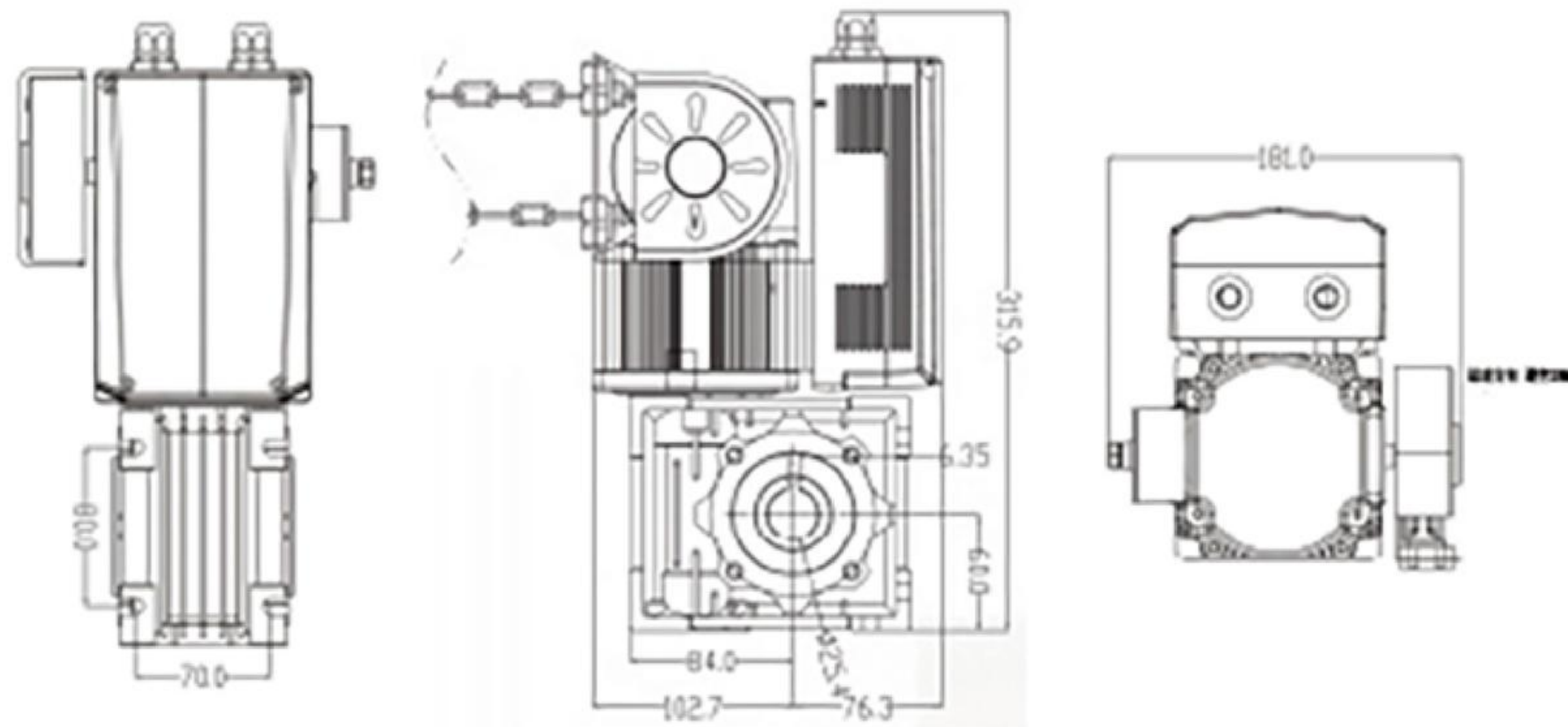

<b>Model</b>	<b>C25</b>
Output Torque	25N.m
Motor Power	300W
Reducer Specification	RV50 1:60
Output Shaft Speed	30 rpm
Input Power Supply	Single - phase (AC220V) ±10%
Input Power Frequency	50/60 Hz
Input Current	220V-4A/110V-8A
Maximum Limit of Rotation	50
Motor Protection Grade	IP54
Hand - pull Chain Length	3m (Maximum extension 8m)
Standard Wire Length	4m
Working Environment Temperature	-20°C - 50°C
Door - closing Buffer Stroke	25.4mm
Power - off Mode	Reducer self - locking
Maximum Number of Operations per Hour	10
Area	Maximum 15 square meters



Integrated Control Box for Lifting Platforms

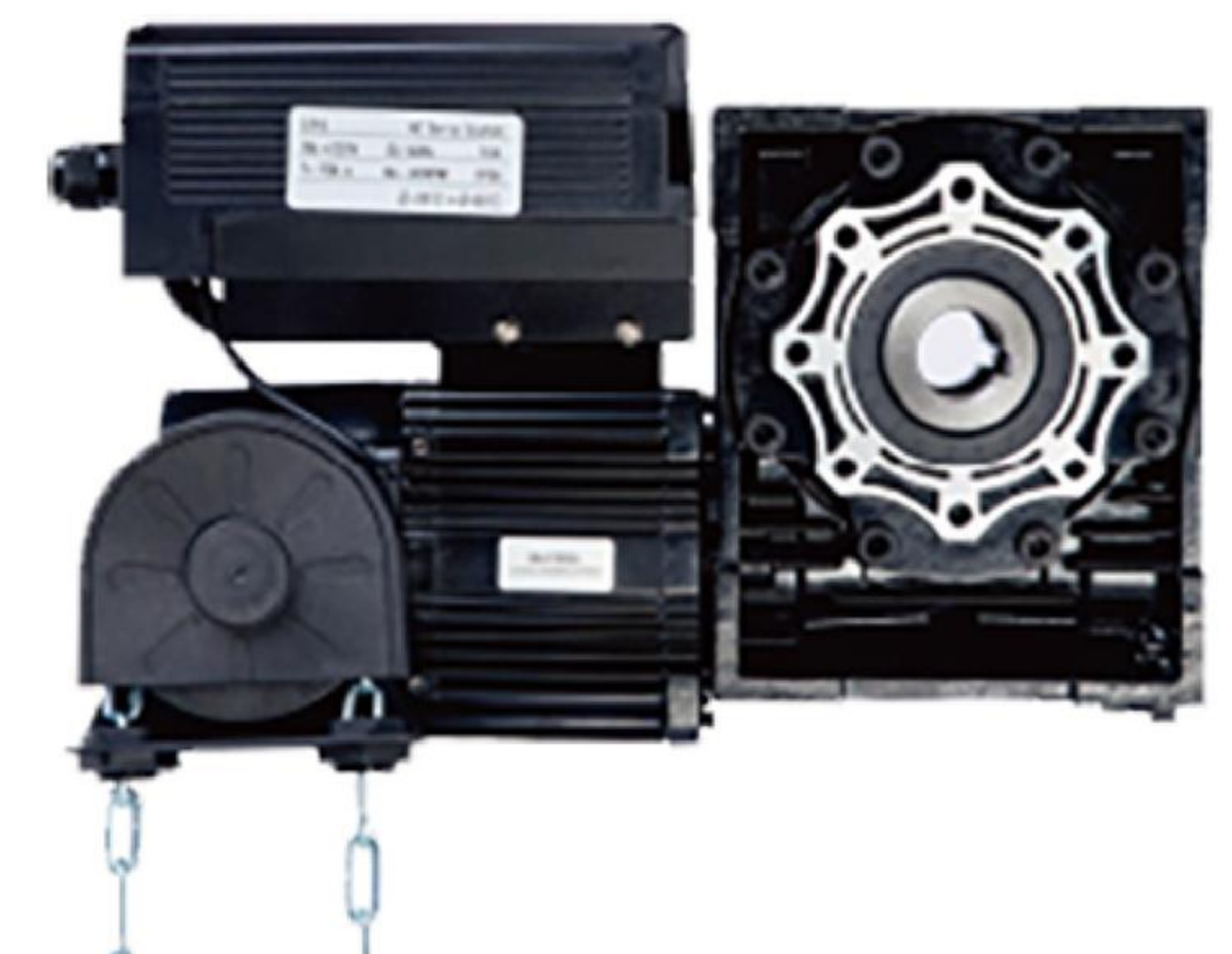

Industrial Overhead Door C60

# Industrial Door Servo System

C35 Model/60N.M/0.65KW Industrial Door Servo System



## Control Box

Configuration Model: Industrial Door C60 Model  
Configuration Power: 60N.M  
Display Screen: LCD Screen (Chinese & English)



## Motor Assembly

Configuration Model: Industrial Door C60 Model  
Operating Power Supply: AC220V ±10%  
Standard Wire Length: 6M

### Dimensional Line Drawing of Industrial Door Control Box

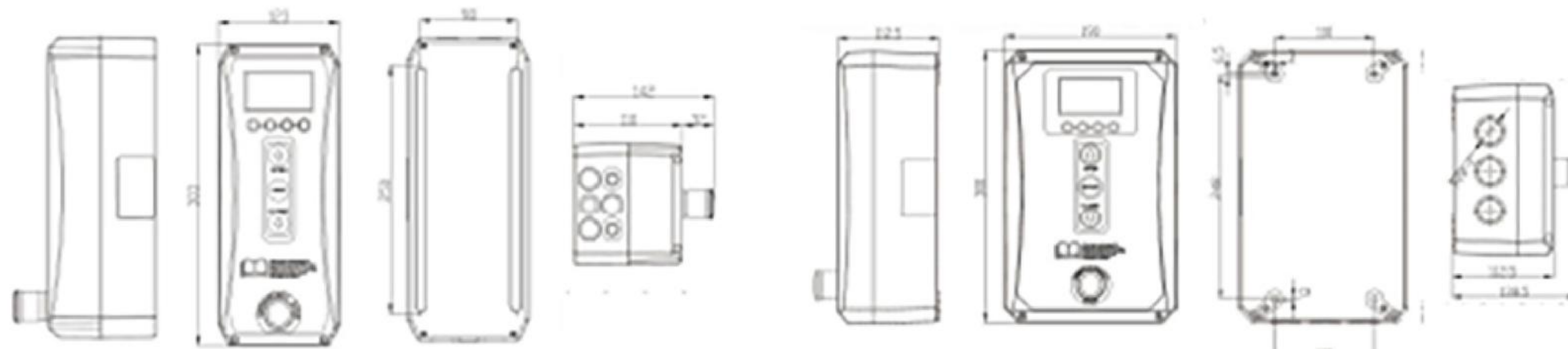

C-Series Small Control Box

C-Series Large Control Box

### Dimensional Line Drawing of Industrial Door Motor Unit

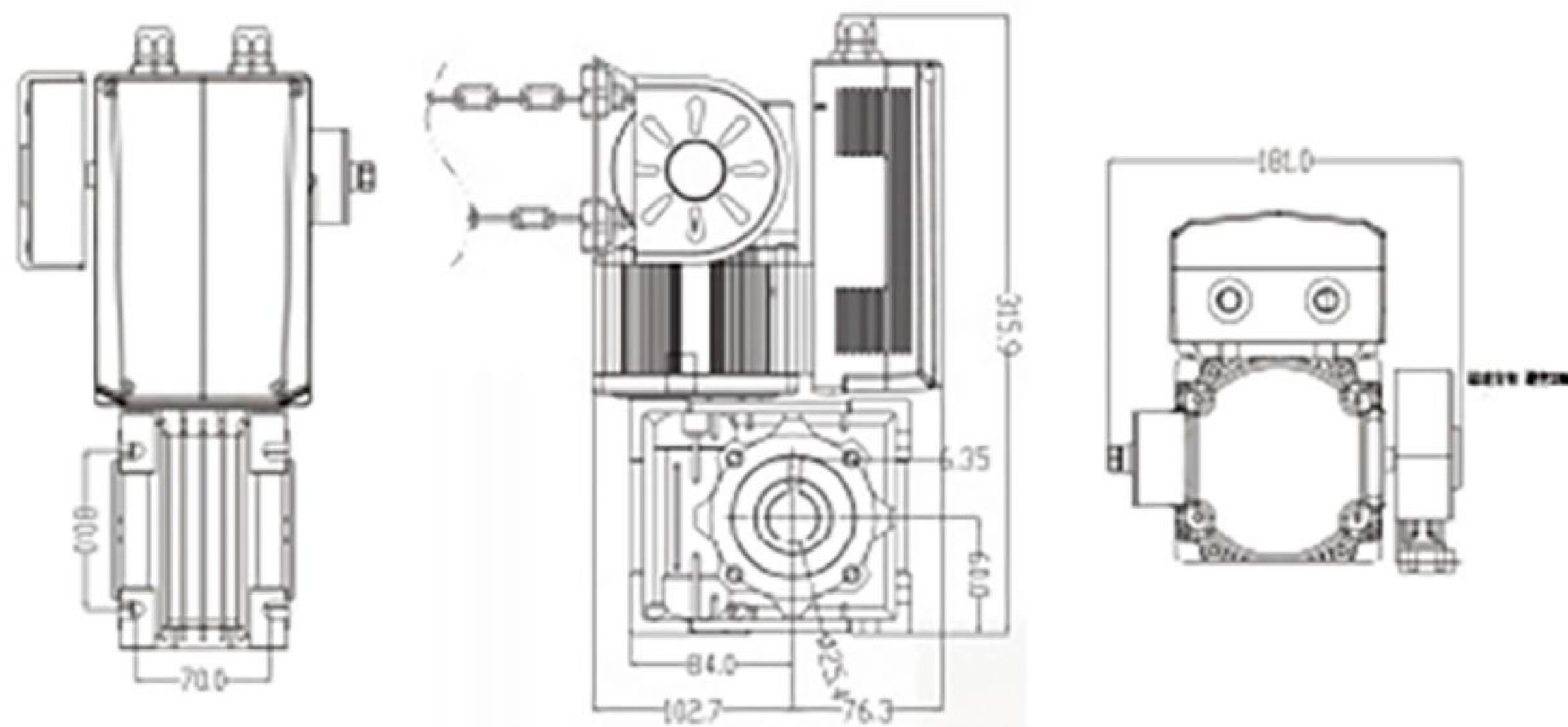

<b>Model</b>	<b>C35</b>
Output Torque	35N.m
Motor Power	400W
Reducer Specification	RV50 1:60
Output Shaft Speed	30 rpm
Input Power Supply	Single - phase (AC220V/110V) ±10%
Input Power Frequency	50/60 Hz
Input Current	220V-4A/110V-8A
Maximum Limit of Rotation	50
Motor Protection Grade	IP54
Hand - pull Chain Length	4m (Maximum extension 8m)
Standard Wire Length	5m
Working Environment Temperature	-20°C - 50°C
Door - closing Buffer Stroke	25.4mm
Power - off Mode	Reducer self - locking
Maximum Number of Operations per Hour	10
Area	Maximum 20 square meters



Integrated Control Box for Lifting Platforms

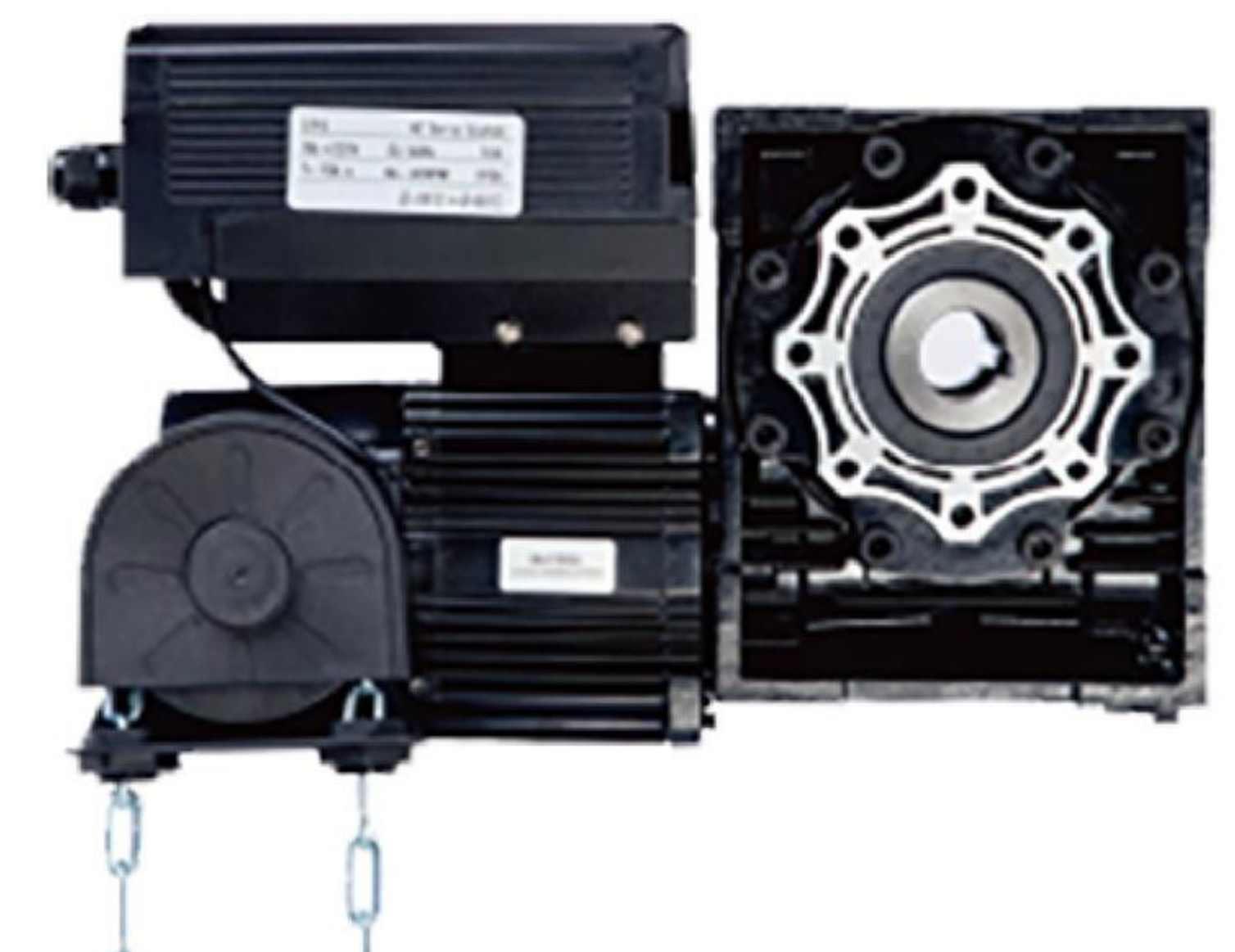

Industrial Overhead Door C60

# Industrial Door Servo System

C40 Model/40N.M/0.45KW Industrial Door Servo System



## Control Box

Configuration Model: Industrial Door C40 Model  
Configuration Power: 40N.M  
Display Screen: LCD Screen (Chinese & English)



## Motor Assembly

Configuration Model: Industrial Door C40 Model  
Operating Power Supply: AC220V±10%  
Standard Wire Length: 5M

### Dimensional Line Drawing of Industrial Door Control Box

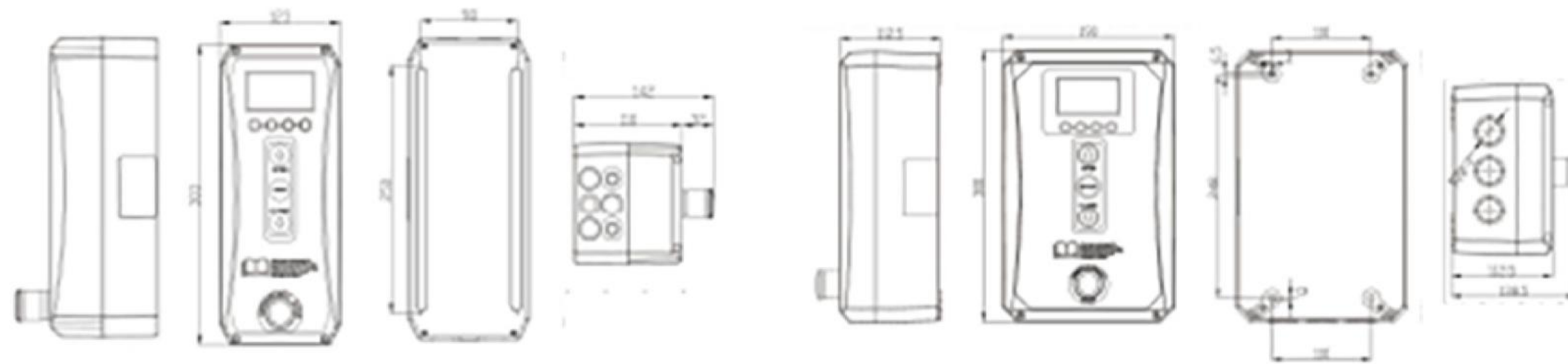

C-Series Small Control Box

C-Series Large Control Box

### Dimensional Line Drawing of Industrial Door Motor Unit

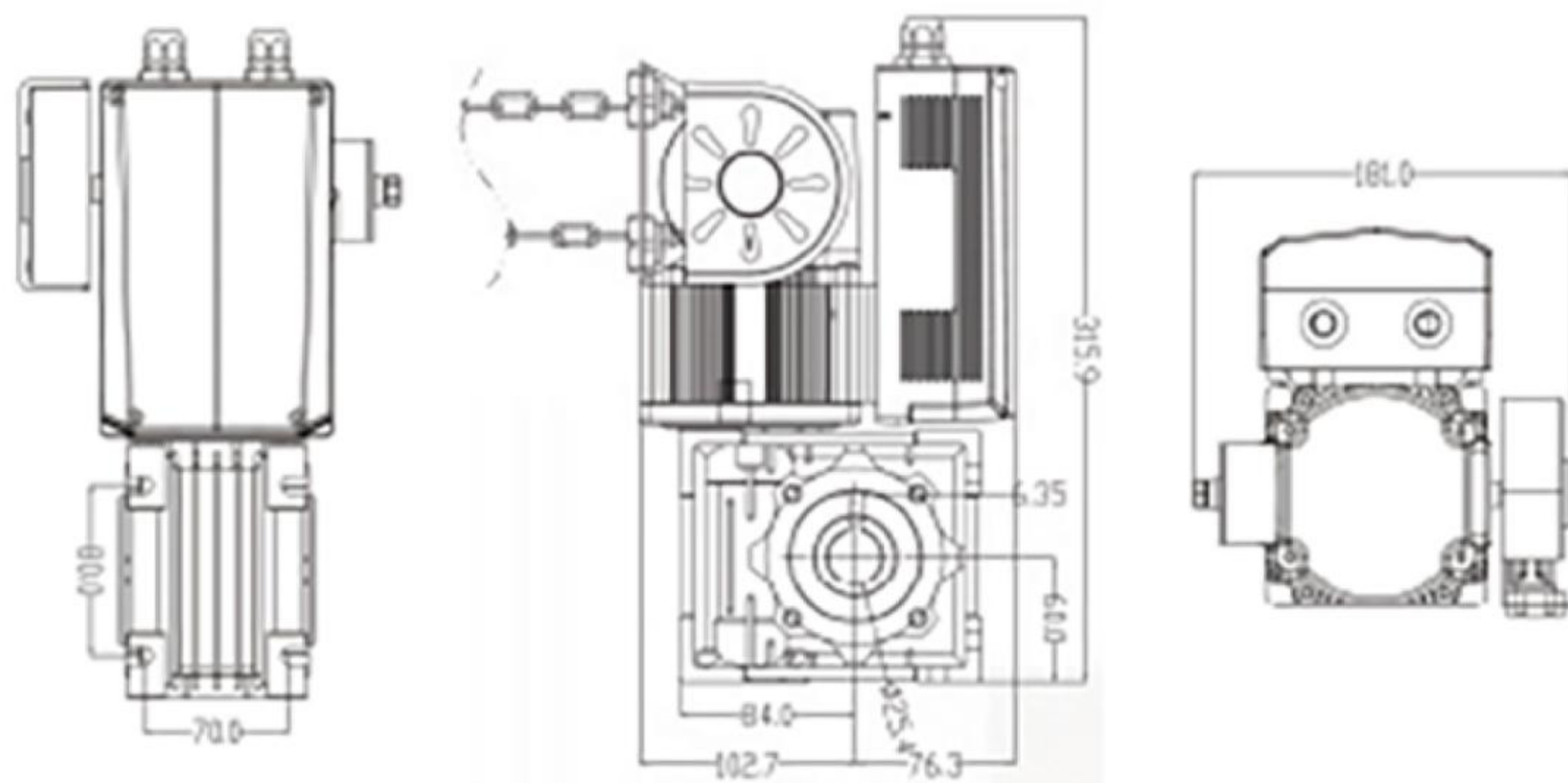

<b>Model</b>	<b>C40</b>
Output Torque	40N.m
Motor Power	450W
Reducer Specification	RV50 1:60
Output Shaft Speed	30 rpm
Input Power Supply	Single - phase (AC220V/110V) ±10%
Input Power Frequency	50/60 Hz
Input Current	220V - 4A/110V - 8A
Maximum Limit of Rotation	50
Motor Protection Grade	IP54
Hand - pull Chain Length	4m (Maximum extension 8m)
Standard Wire Length	5m
Working Environment Temperature	-20°C - 50°C
Door - closing Buffer Stroke	25.4mm
Power - off Mode	Reducer self - locking
Maximum Number of Operations per Hour	10
Area	16 - 25 square meters



Integrated Control Box for Lifting Platforms

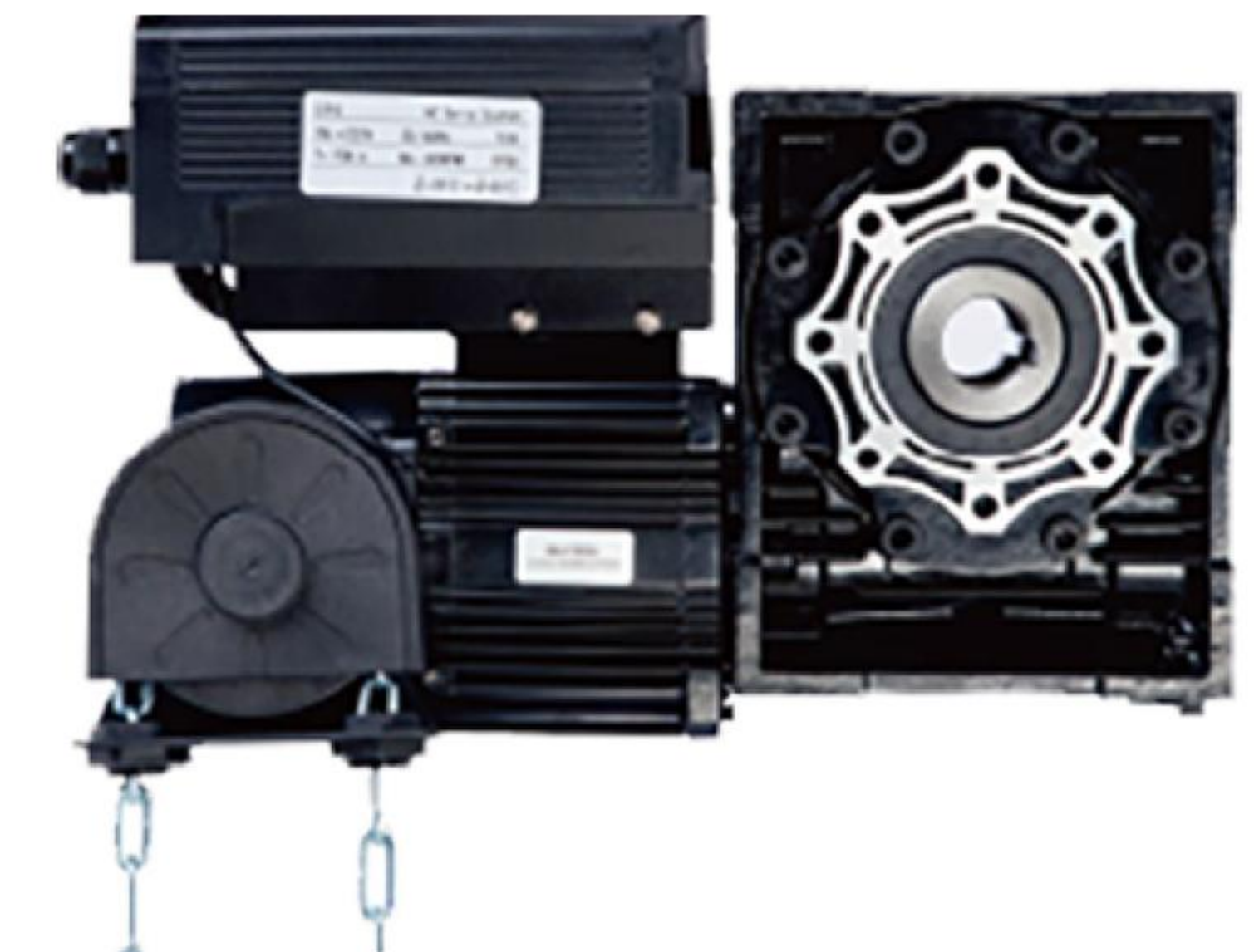

Industrial Overhead Door C40

# Industrial Door Servo System

C60 Model/60N.M/0.65KW Industrial Door Servo System



## Control Box

Configuration Model: Industrial Door C60 Model  
Configuration Power: 60N.M  
Display Screen: LCD Screen (Chinese & English)



## Motor Assembly

Configuration Model: Industrial Door C60 Model  
Operating Power Supply: AC220V ±10%  
Standard Wire Length: 6M

### Dimensional Line Drawing of Industrial Door Control Box

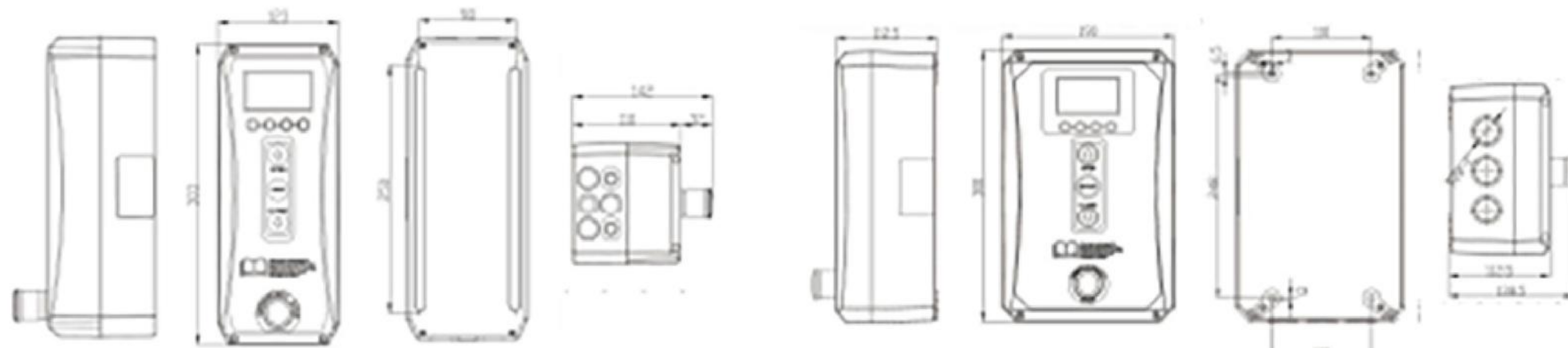

C-Series Small Control Box

C-Series Large Control Box

### Dimensional Line Drawing of Industrial Door Motor Unit

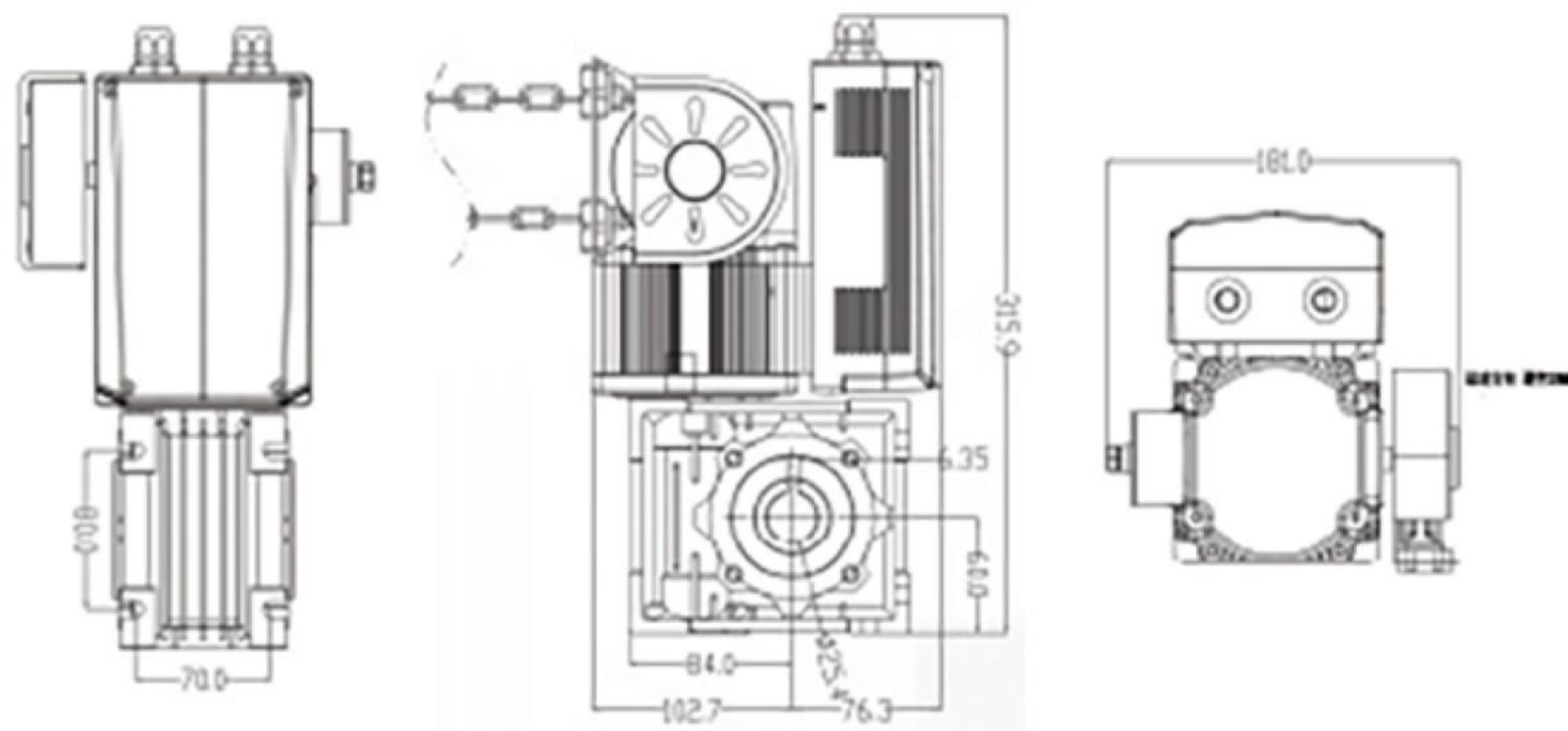

<b>Model</b>	<b>C60</b>
Output Torque	60N.m
Motor Power	650W
Reducer Specification	RV50 1:60
Output Shaft Speed	30 rpm
Input Power Supply	Single - phase (AC220V/110V) ±10%
Input Power Frequency	50/60 Hz
Input Current	220V - 6A/110V - 12A
Maximum Limit of Rotation	50
Motor Protection Grade	IP54
Hand - pull Chain Length	5.5m (Maximum extension 8m)
Standard Wire Length	6m
Working Environment Temperature	-20°C - 50°C
Door - closing Buffer Stroke	25.4mm
Power - off Mode	Reducer self - locking
Maximum Number of Operations per Hour	10
Area	25 - 30 square meters



Integrated Control Box for Lifting Platforms

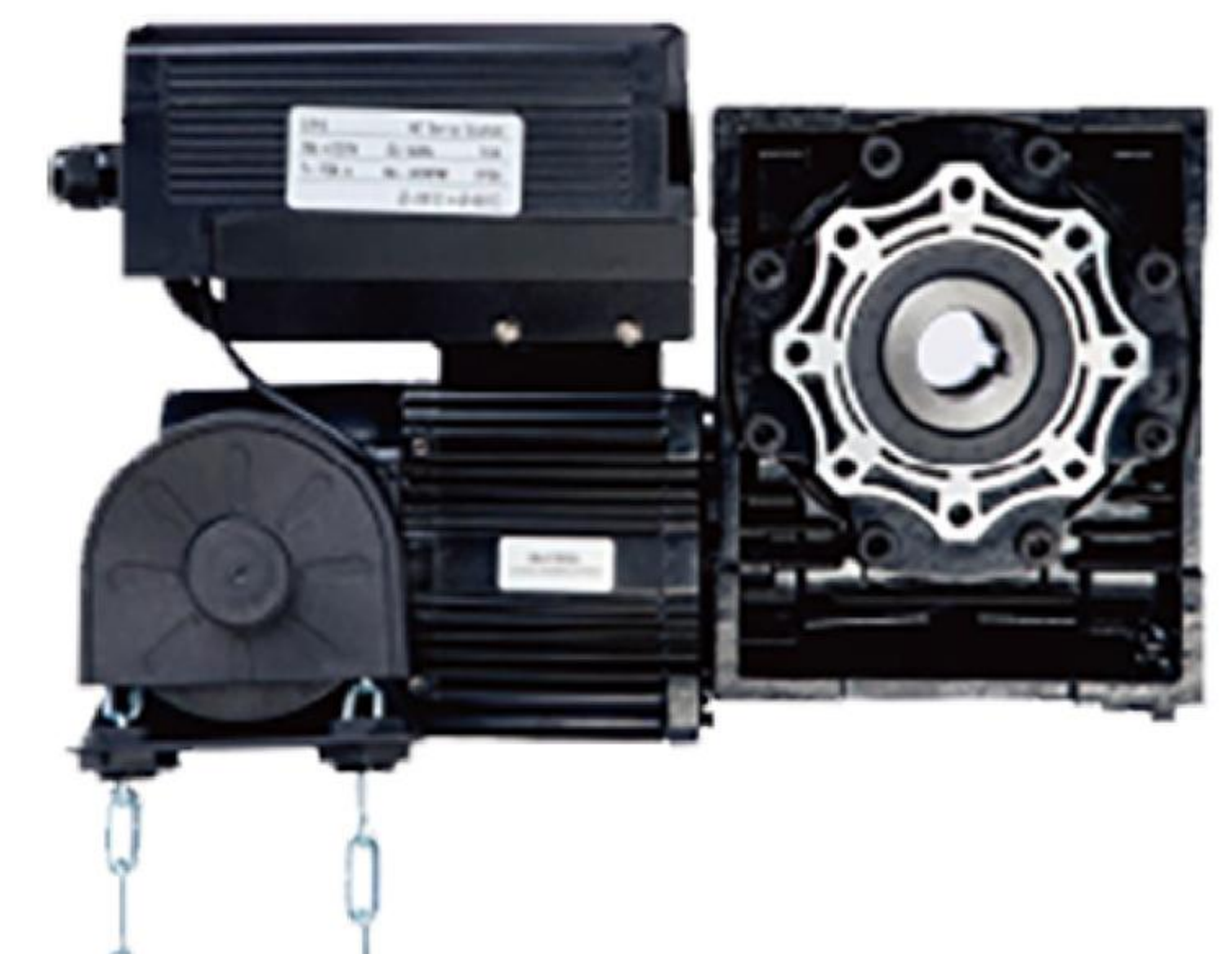

Industrial Overhead Door C60

# Industrial Door Servo System

C90 Model/90N.M/1.1KW Industrial Door Servo System



## Control Box

Configuration Model: Industrial Door C90 Model  
Configuration Power: 90N.M  
Display Screen: LCD Screen (Chinese & English)



## Motor Assembly

Configuration Model: Industrial Door C90 Model  
Operating Power Supply: AC220V±10%  
Standard Wire Length: 9M

### Dimensional Line Drawing of Industrial Door Control Box

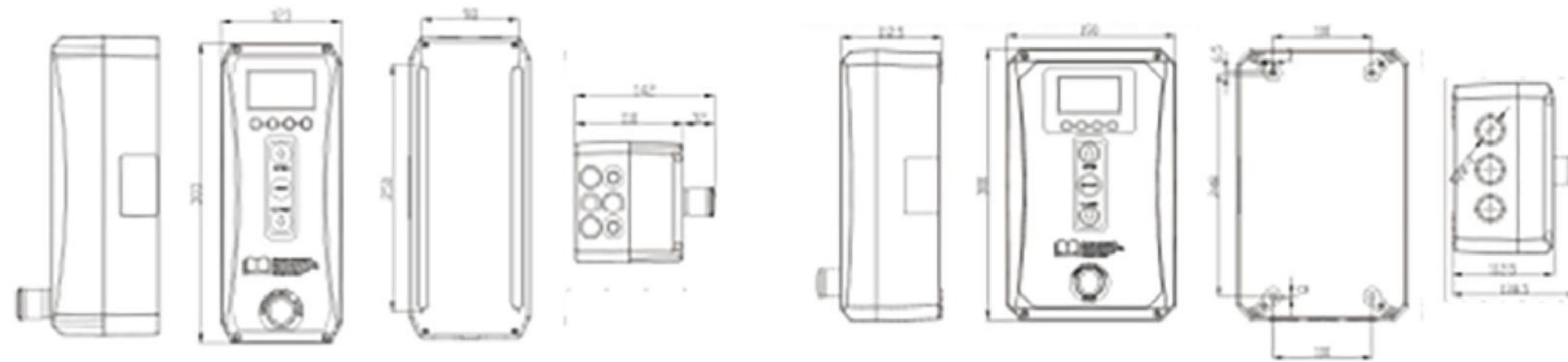

C-Series Small Control Box

C-Series Large Control Box

### Dimensional Line Drawing of Industrial Door Motor Unit

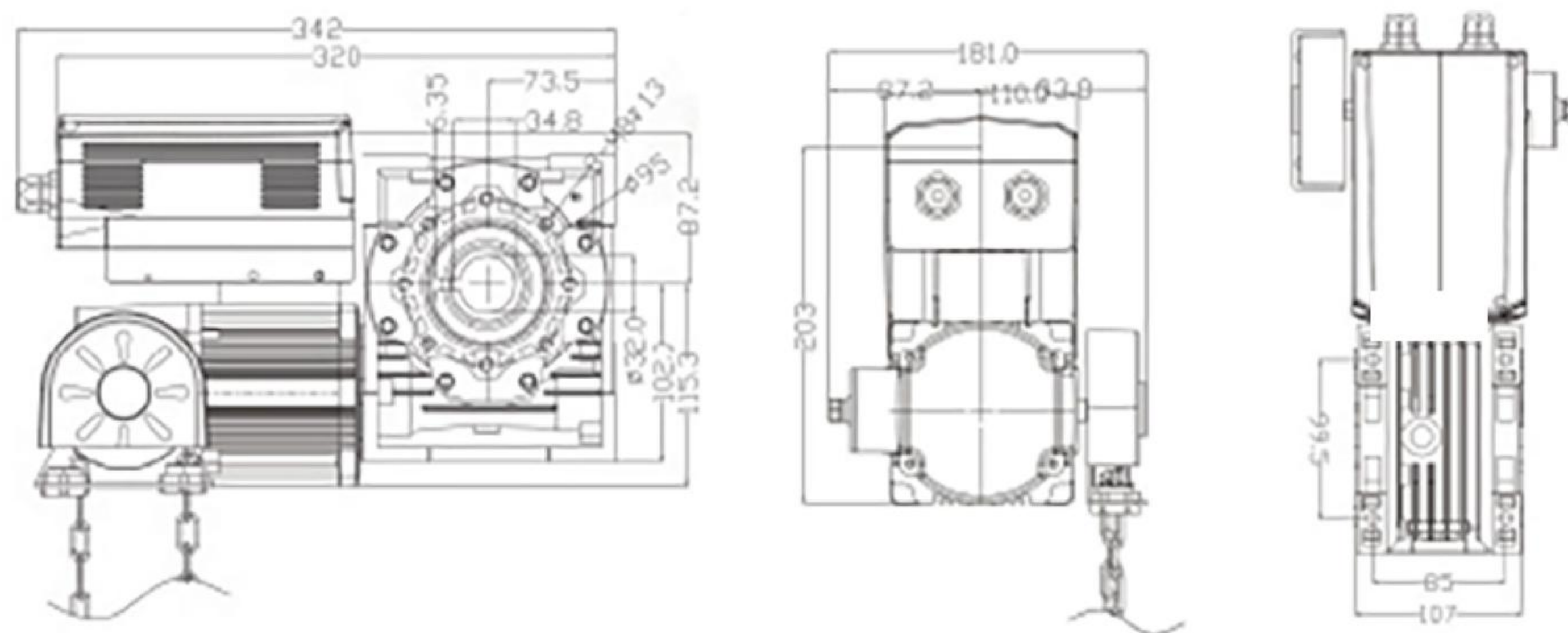

<b>Model</b>	<b>C90</b>
Output Torque	90N.m
Motor Power	1100W
Reducer Specification	RV63 1:80
Output Shaft Speed	30 rpm
Input Power Supply	Single - phase (AC220V/110V) ±10%
Input Power Frequency	50/60 Hz
Input Current	220V - 11A/110V - 19A
Maximum Limit of Rotation	40
Motor Protection Grade	IP54
Hand - pull Chain Length	8m (Maximum extension 8m)
Standard Wire Length	9m
Working Environment Temperature	-20°C - 50°C
Door - closing Buffer Stroke	25.4mm/32mm
Power - off Mode	Reducer self - locking
Maximum Number of Operations per Hour	10
Area	35 - 45 square meters



Integrated Control Box for Lifting Platforms

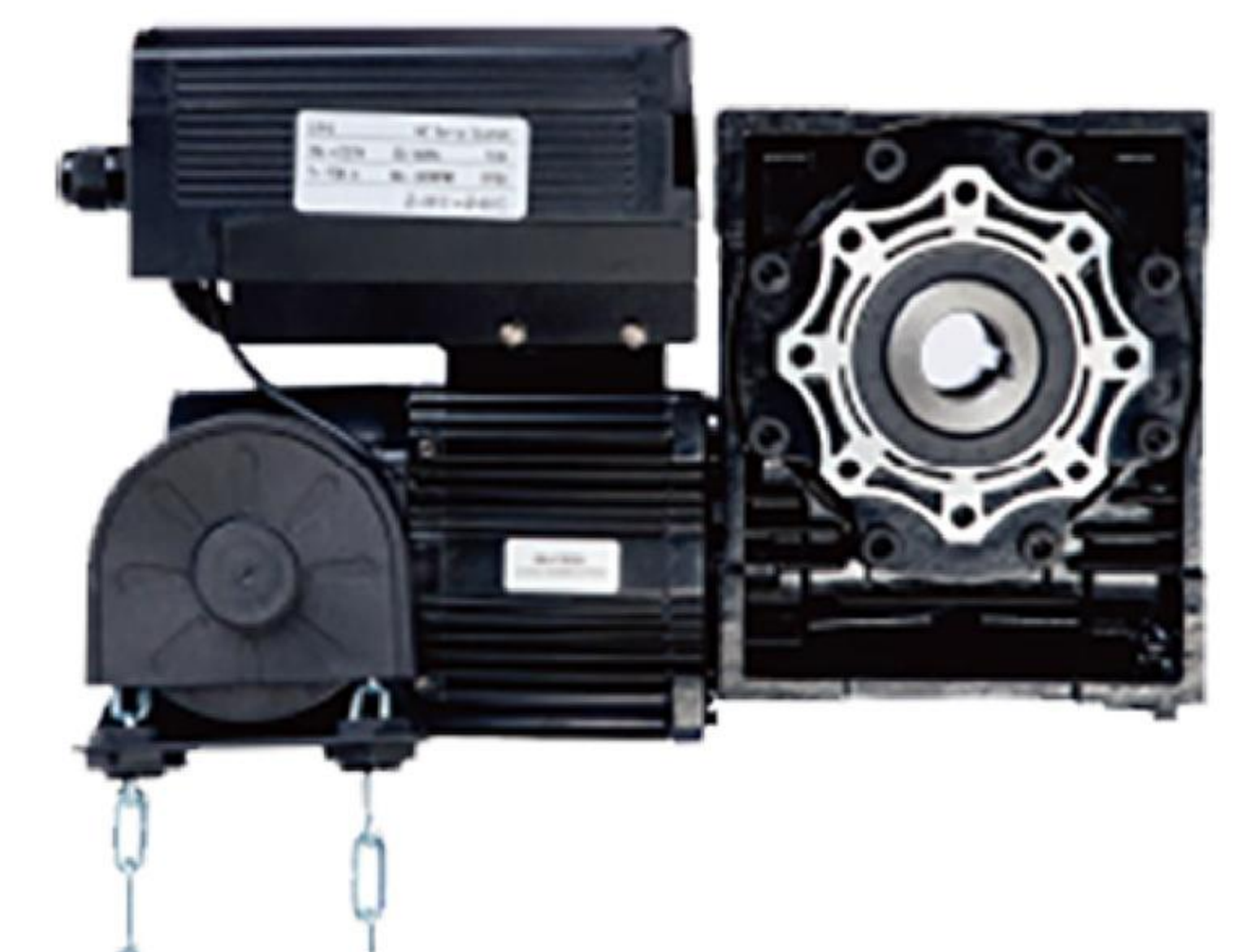

Industrial Overhead Door C90

# Industrial Door Servo System

C120 Model/120N.M/1.5KW Industrial Door Servo System



## Control Box

Configuration Model: Industrial Door C120 Model  
Configuration Power: 120N.M  
Display Screen: LCD Screen (Chinese & English)



## Motor Assembly

Configuration Model: Industrial Door C120 Model  
Operating Power Supply: AC220V ±10%  
Standard Wire Length: 9M

### Dimensional Line Drawing of Industrial Door Control Box



C-Series Small Control Box

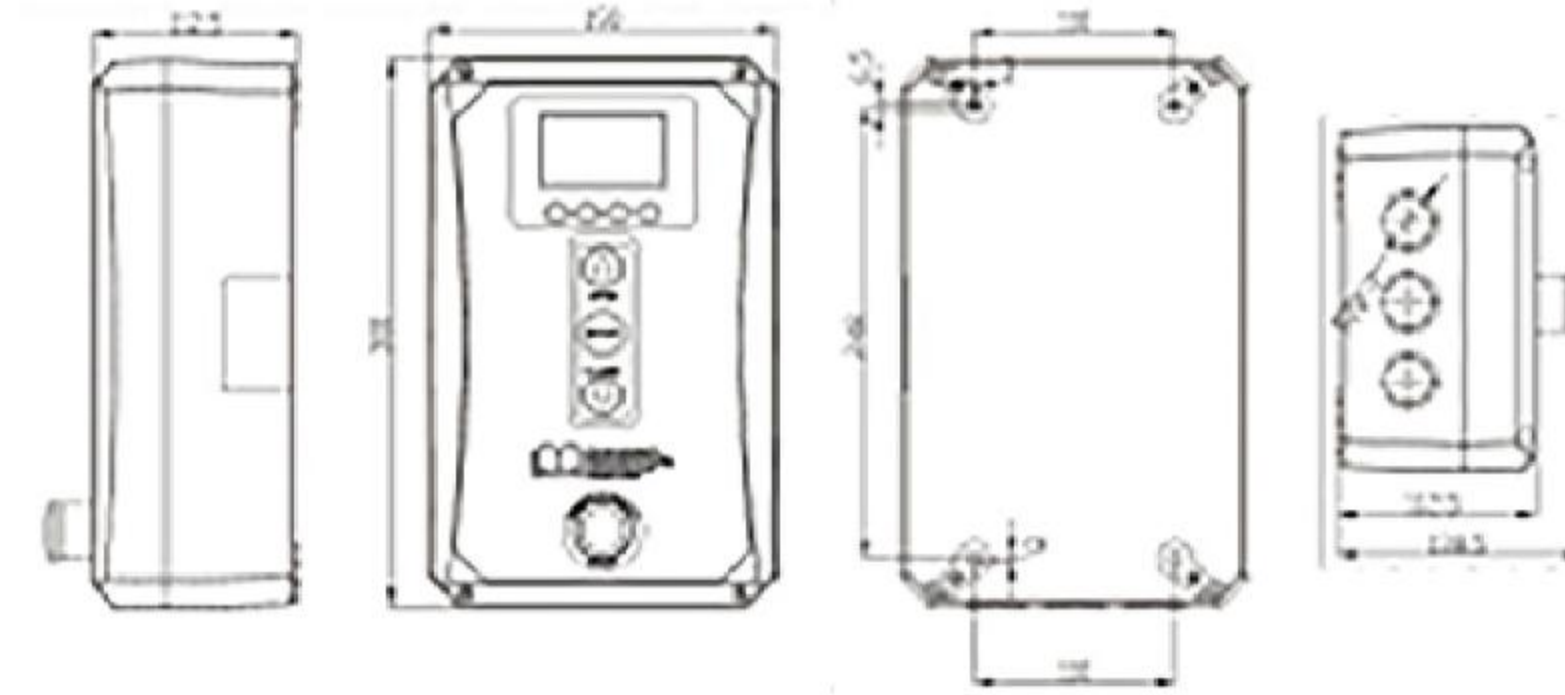

C-Series Large Control Box

### Dimensional Line Drawing of Industrial Door Motor Unit

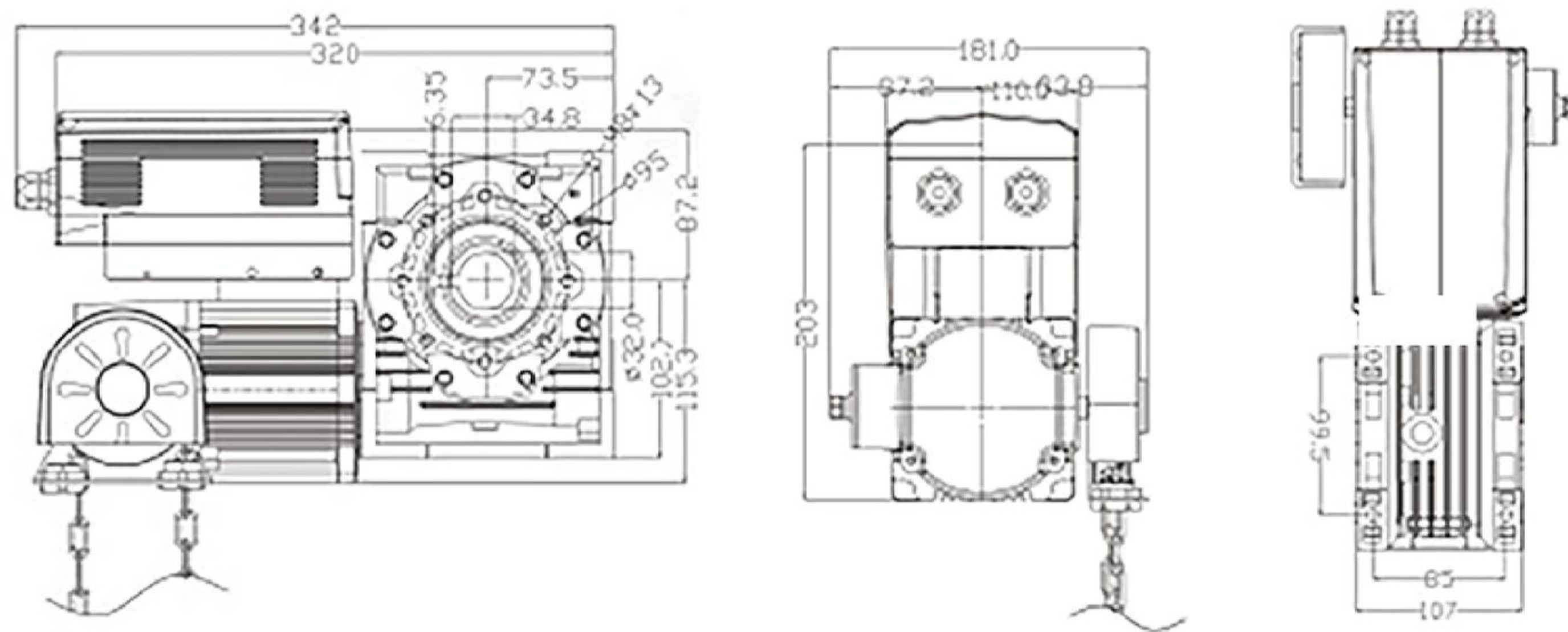

<b>Model</b>	<b>C120</b>
Output Torque	120N.m
Motor Power	1500W
Reducer Specification	RV63 1:80
Output Shaft Speed	30 rpm
Input Power Supply	Single - phase (AC220V/110V) ±10%
Input Power Frequency	50/60 Hz
Input Current	220V - 13A/110V - 26A
Maximum Limit of Rotation	40
Motor Protection Grade	IP54
Hand - pull Chain Length	8m
Standard Wire Length	9m
Working Environment Temperature	-20°C - 50°C
Door - closing Buffer Stroke	25.4mm/32mm
Power - off Mode	Reducer self - locking
Maximum Number of Operations per Hour	10
Area	45 - 55 square meters

Motor Power	Speed Reducer Ratio	Lifting Force	Lifting Speed (16J Lattice)	Applicable Area
1500W	80	120N.m	0.3m/s	55m <sup>2</sup>



Integrated Control Box for Lifting Platforms

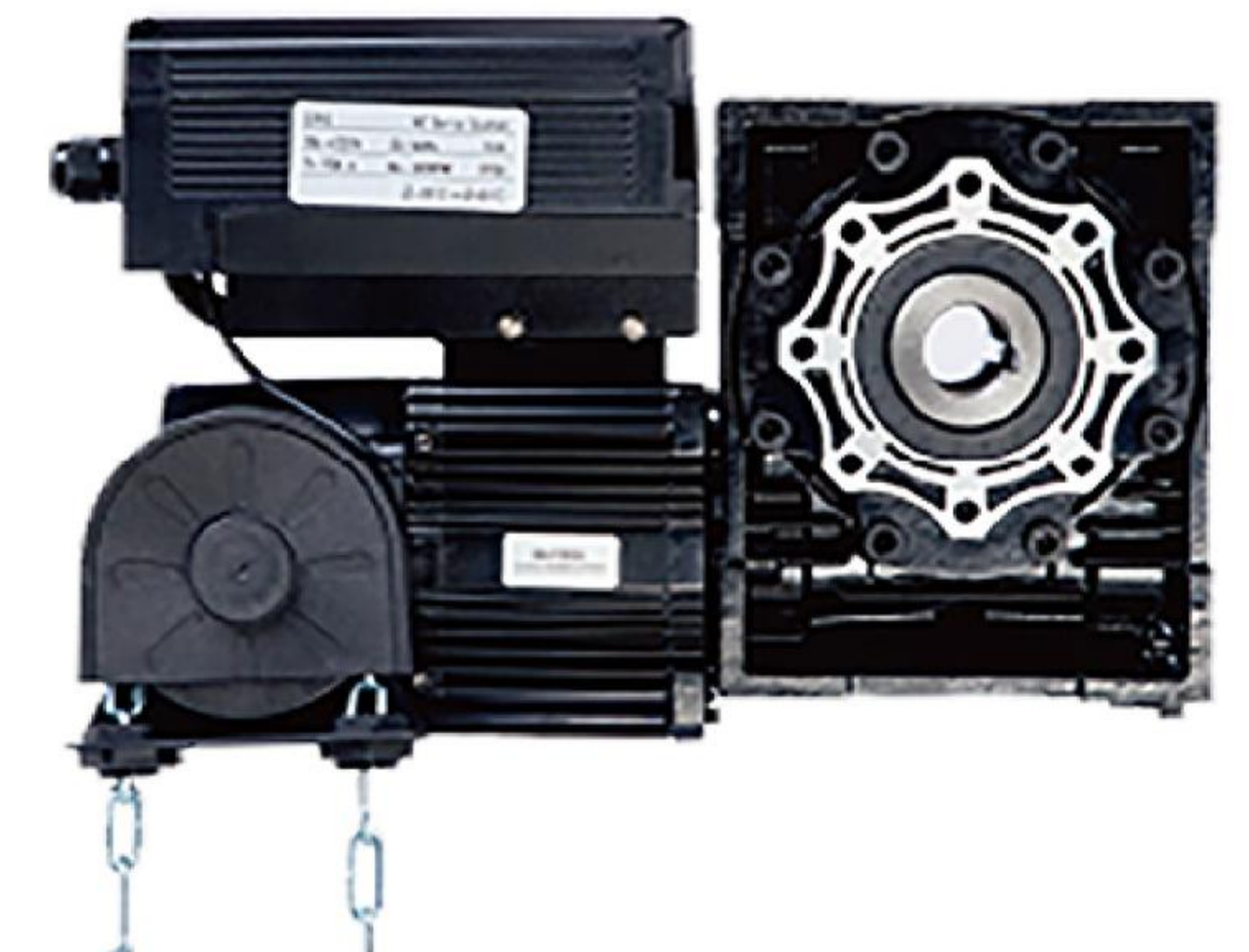

Industrial Overhead Door C120